

FINAL REVIEW OF OPTIONS

May 01, 2012



University of Lethbridge:
University Campus Master Plan



Moriyama Teshima
Architects & Planners

Gibbs | Gage
ARCHITECTS





Lethbridge





The two Campus Master Plan options illustrated in this presentation respond to a unique prairie and geological landscape...

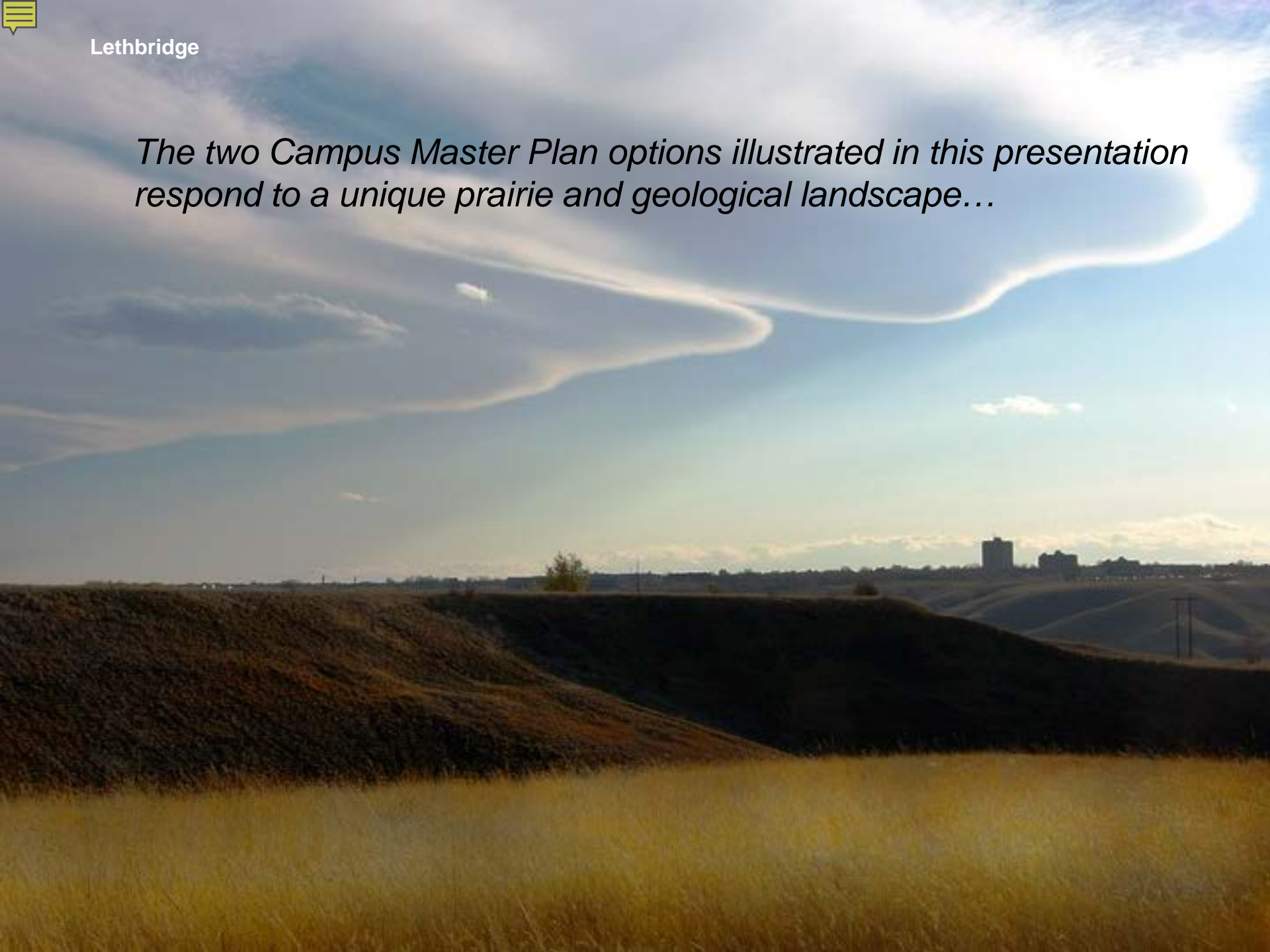



Both options reassess the configuration, program and quality of the current University campus.





*In both **Option A** and **Option B**, Aperture Drive West regains its original source of emphasis.*





1. ***Option A***, shows an emphasis of buildings connecting with *Exploration Place Park*; and
2. ***Option B***, focuses on a south extension of *University Hall*.





The preferred Campus Master Plan should harmonize both the pragmatics and poetics of "what constitutes a campus" -- securing the University's long-term viability as a "unique-in-the-world" destination Campus.





Lethbridge



Lethbridge



Lethbridge



Lethbridge



Lethbridge



Lethbridge



Lethbridge



Lethbridge



Lethbridge



Lethbridge





Lethbridge

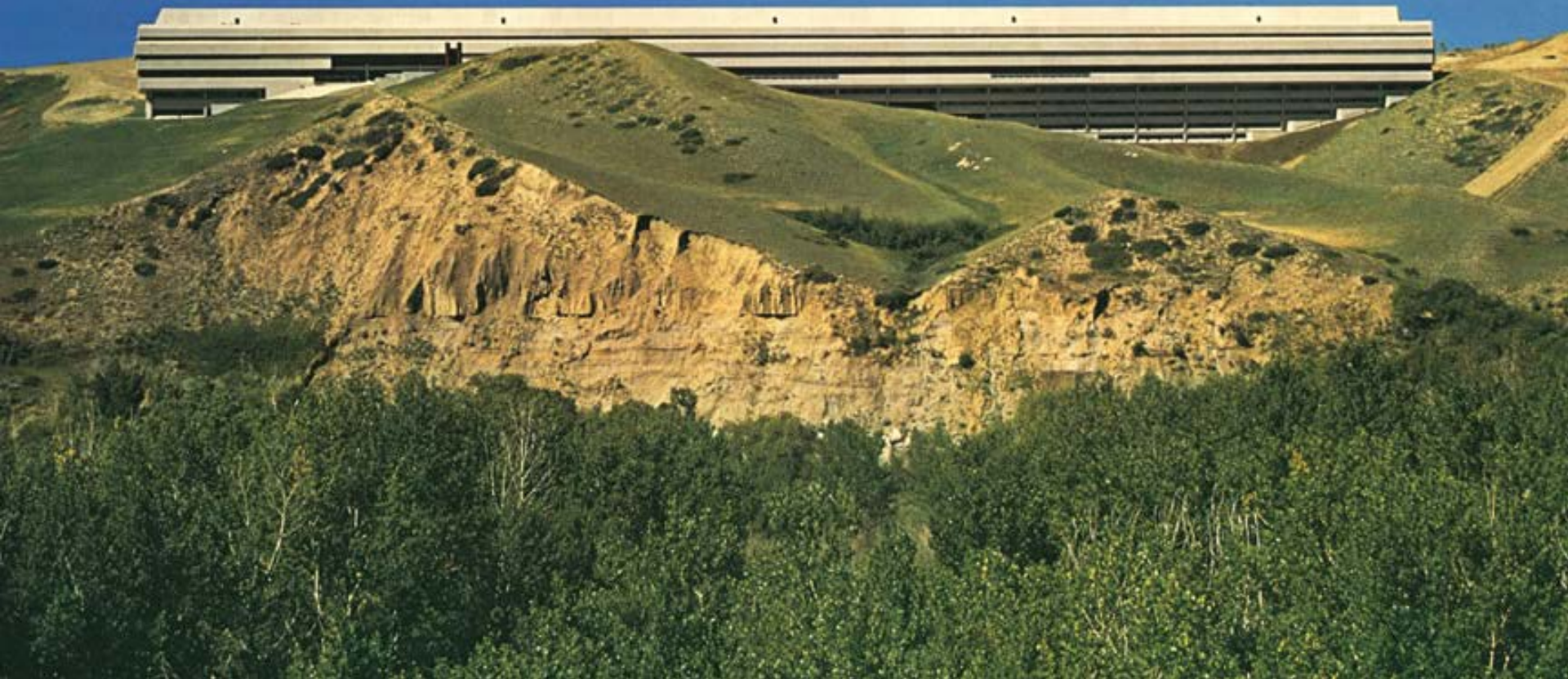





Gateways

How does the University of Lethbridge create a Campus that is universally welcome and engaging?



*Syracuse University
Syracuse, NY*



University of Lethbridge

Design Objective: Create gateways to the campus which clearly identify the University of Lethbridge within its surrounding context, while communicating and displaying to the neighbouring community the University's brand.

Experience of Arrival

How will the University of Lethbridge create a sense of destination?



*Bard College
Annandale-on-Hudson, NY*



University of Lethbridge

Design Objective: Reinforce existing visual and pedestrian axis within the campus and create new ones. Create a series of 'desire lines' that make walking across the University campus easy and pleasurable.

Vibrant public spaces

How can the University of Lethbridge build more social spaces?



*Virginia Commonwealth University
Richmond, VA*



University of Lethbridge

Design Objective: Create a tight pedestrian-oriented core to the campus with an environment conducive to academic excellence and vibrant student life, as well as a comfortable pedestrian Microclimate in the heart of the campus.

Sustainability

How will the University of Lethbridge continue to transform the University into a sustainable community?



*Drake University
Des Moines, IA*



University of Lethbridge

Design Objective: Enhance 'green' accessibility to the University campus – transit, cycling, and facilitating pedestrian movement.

Safety and Security

How will the University of Lethbridge ensure a 24/7 campus?



*Bryn Athyn College
Bryn Athyn, PA*



University of Lethbridge

Design Objective: Provide transparency and accessibility at grade, as well as programs, which are conducive to social interaction and enhance a strong sense of collegiality.

Outdoor Space

How will the University of Lethbridge enhance and use existing outdoor space?



*UCLA
Los Angeles, CA*



University of Lethbridge

Design Objective: Define the public realm core of the campus through signature elements of landscape, urban furniture, and lighting to create a cohesive collegial sense of community and where coulees are protected and utilized as celebrated open space, surrounded by University uses.



Enhancement of the Campus Master Plan: 2012

Our Team has proposed three overarching directions, developed through an extensive consultation process. Summarized, these include:

- Opportunities provided for students, faculty, researchers, and staff to meet and interact on campus while new buildings or the reconfiguration-of-existing buildings will feature multi-functionality to attract broad cross-sections of the campus community;
- Strengthen the quality of the built and natural environments to help brand the University as a destination institution, with particular emphasis on improving campus life and student experiences; and
- Demonstrate leadership in the management and planning of building assets and the careful stewardship of land holdings.

Key Physical Drivers

Key Physical Drivers were developed that would structure subsequent design work based on the three overarching. These include:

- Campus Gateway on and giving primacy to Aperture Drive;
- Framing a “Coulee-Quad” and campus heart;
- Interconnected buildings (academic, residential) that engage the coulee;
- Unique brand of architecture fully integrated with landscape; and
- Creating a unique Campus identity and experience

Key Physical Drivers

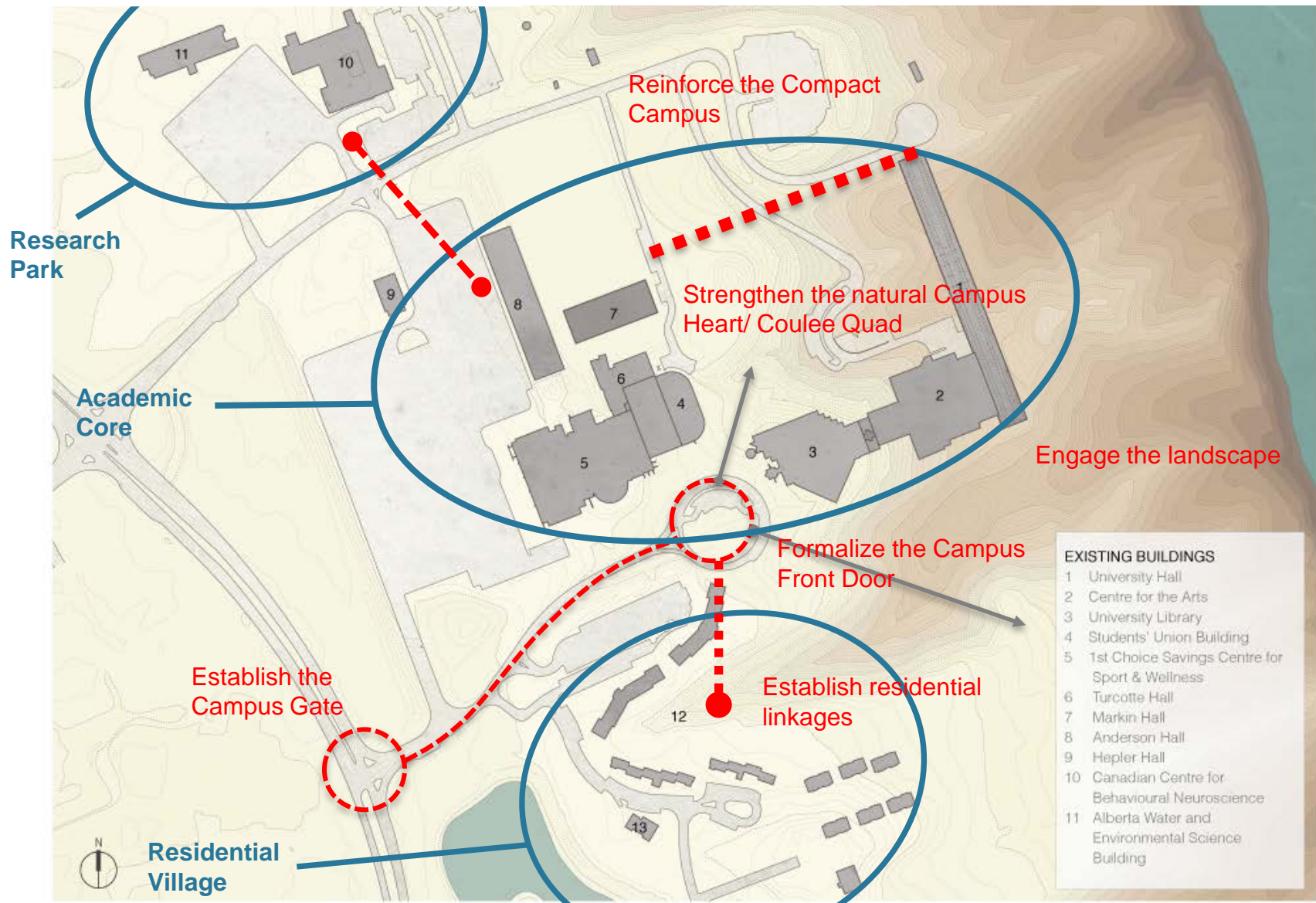

The Campus in the Future: A Destination Campus

Reinforcing the presence of the Campus in its natural setting
and creating a Destination Institution



Beatty Biodiversity Center & Aquatic
Ecosystems Research Laboratory, Vancouver, Canada



Simon Fraser University, Burnaby, Canada



Oslo School of Architecture, Oslo, Norway



- 10 University Hall
- 11 Centre for the Arts
- 12 University Library
- 13 Students' Union Building
- 14 Max Bell Regional Aquatic Centre
- 15 1st Choice Savings Centre for Sport & Wellness
- 16 Turocotte Hall
- 17 Merkin Hall
- 18 Canadian Centre for Behavioural Neuroscience
- 19 Alberta Weyer & Environmental Science Building

- 20 Daycare
- 21 Peterson Centre
- 22 Kukul House
- 23 Pikani House
- 24 Shaska House
- 25 Tsou T'ina House
- 26 Residential Village
- 27 &
- 28 Proposed Academic Buildings
- 29 Proposed Residential Buildings



Delft University of Technology, Delft, Netherlands



Becton Dickinson Campus, Franklin Lakes, USA



Vanke Complex Shenzhen, Shenzhen, China

Precedent: Hillside Art Center, Pasadena



Precedent: Hillside Art Center, Pasadena



Precedent: Simon Fraser University, Burnaby



Precedent: Simon Fraser University, Burnaby



Precedent: Simon Fraser University, Burnaby



Precedent: Haifa University

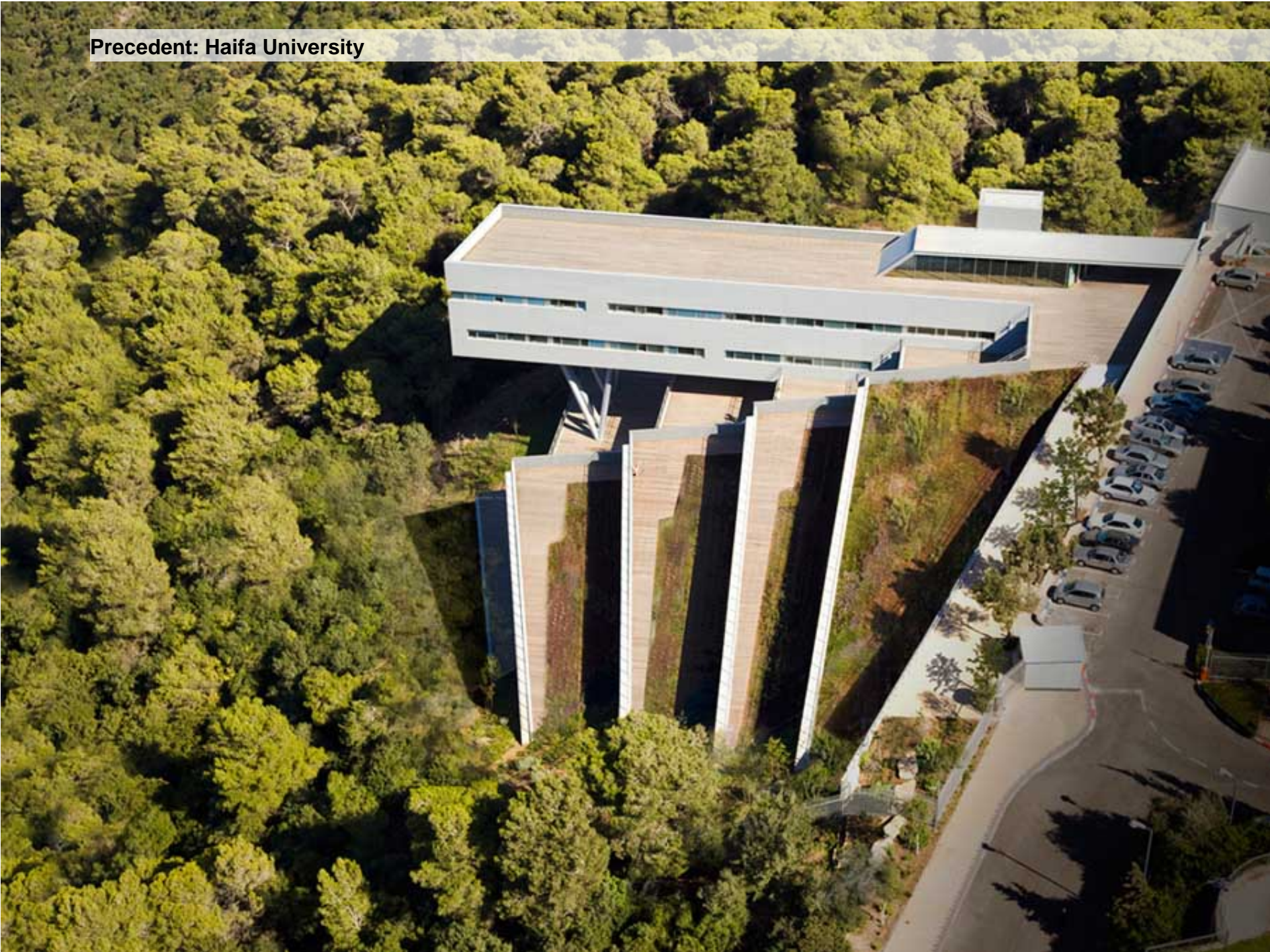





Precedent: Ewha University, Seoul



Precedent: Ewha University, Seoul



Precedent: Delft Library



Precedent: Milstein Hall, Cornell University, Ithaca



Precedent: Seoul National University



Precedent: Shanghai Giant Headquarters



Precedent: Shanghai Giant Headquarters



Precedent: Oslo School of Architecture



Precedent: Oslo School of Architecture



Precedent: Vanke Complex, Shenzhen



Precedent: Vanke Complex, Shenzhen

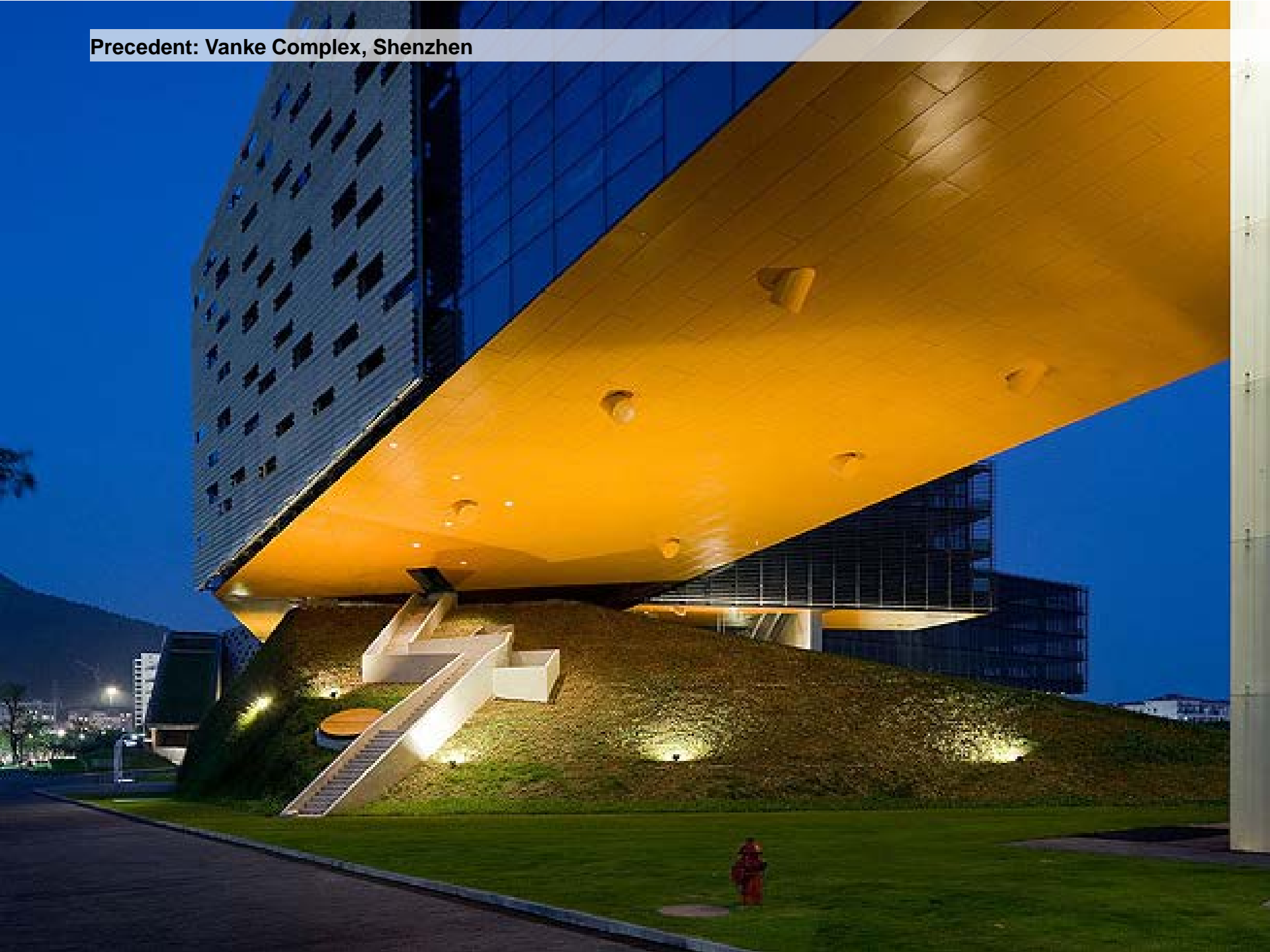

Precedent: Becton Dickinson Campus, New Jersey



Options: A, B



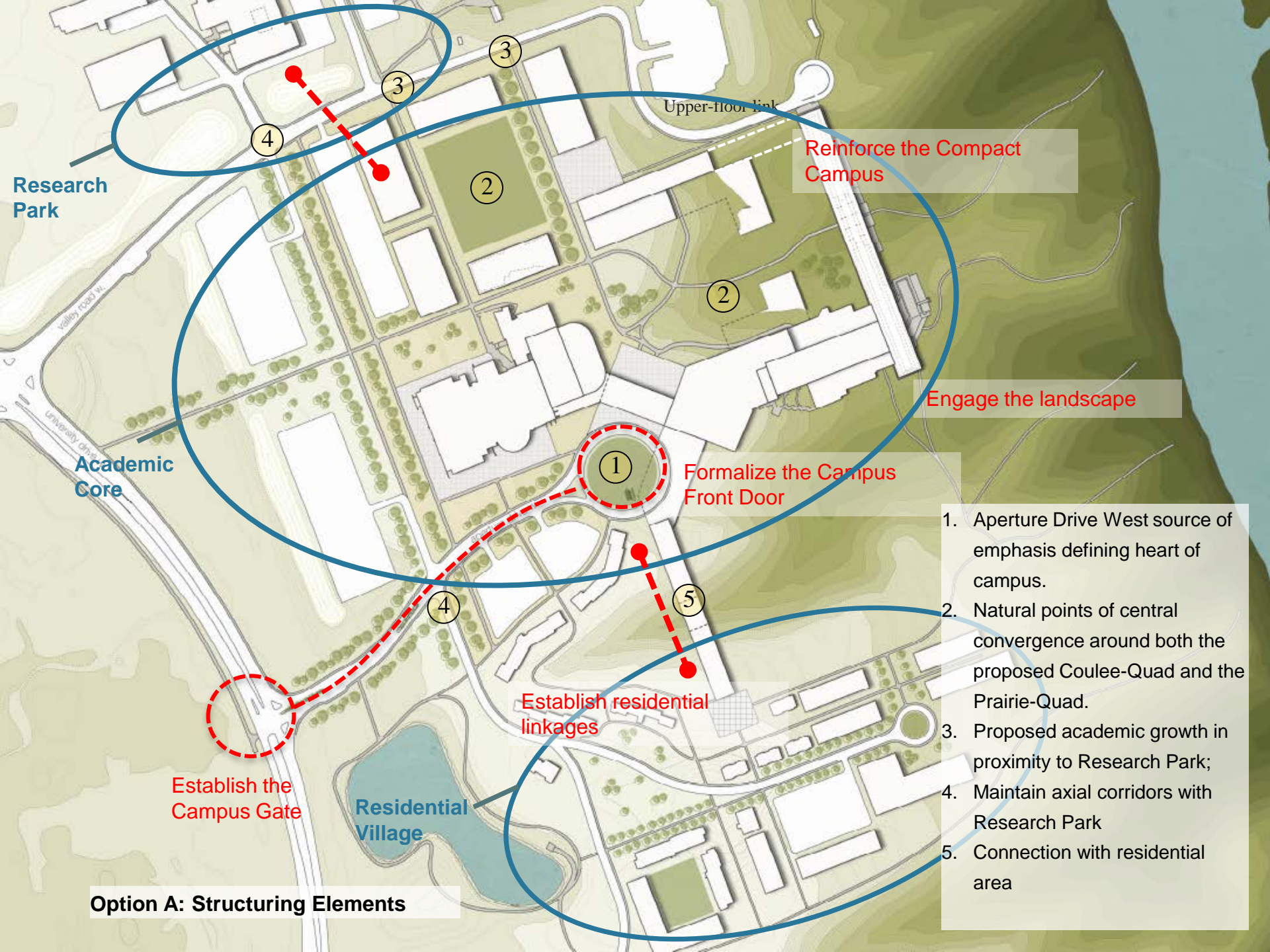

Research Park

Academic Core

Residential Village

Upper-floor link

Reinforce the Compact Campus

Engage the landscape

Formalize the Campus Front Door

Establish residential linkages

Establish the Campus Gate

Option A: Structuring Elements

1. Aperture Drive West source of emphasis defining heart of campus.
2. Natural points of central convergence around both the proposed Coulee-Quad and the Prairie-Quad.
3. Proposed academic growth in proximity to Research Park;
4. Maintain axial corridors with Research Park
5. Connection with residential area

Option A:

The Campus in the Future

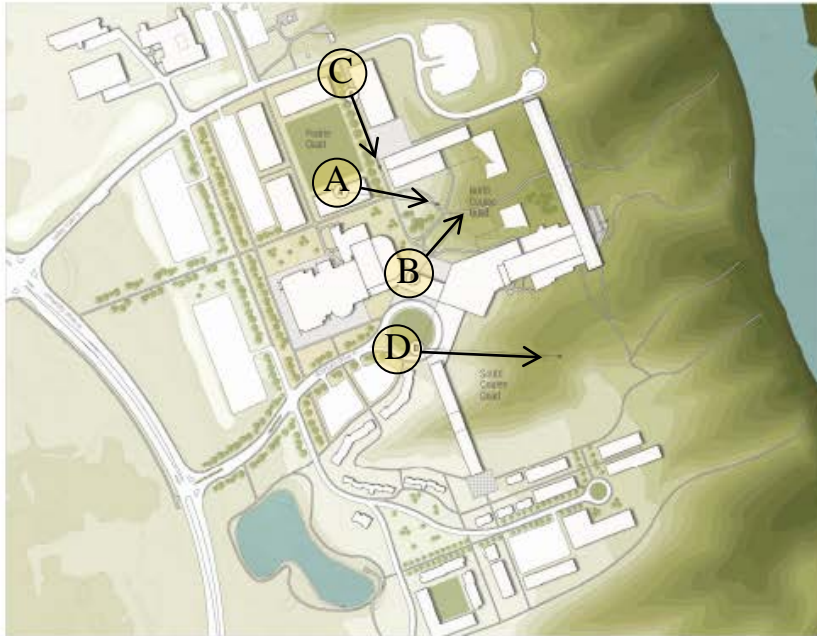

Option A:

Aperture Drive West will regain its original source of emphasis and define a new heart of campus. This will help identify a visible and natural point of convergence around both the proposed Coulee-quad and the Prairie-quad where students, faculty and staff will meet, socialize and access key services. The location of this core will help re-calibrate the campus and will concentrate services and amenities to create the kind of density that attracts people and makes them want to spend time on campus.

Option A: View along Aperture Drive towards proposed Bridge



Option A: Bird's eye view of Coulee-Quad

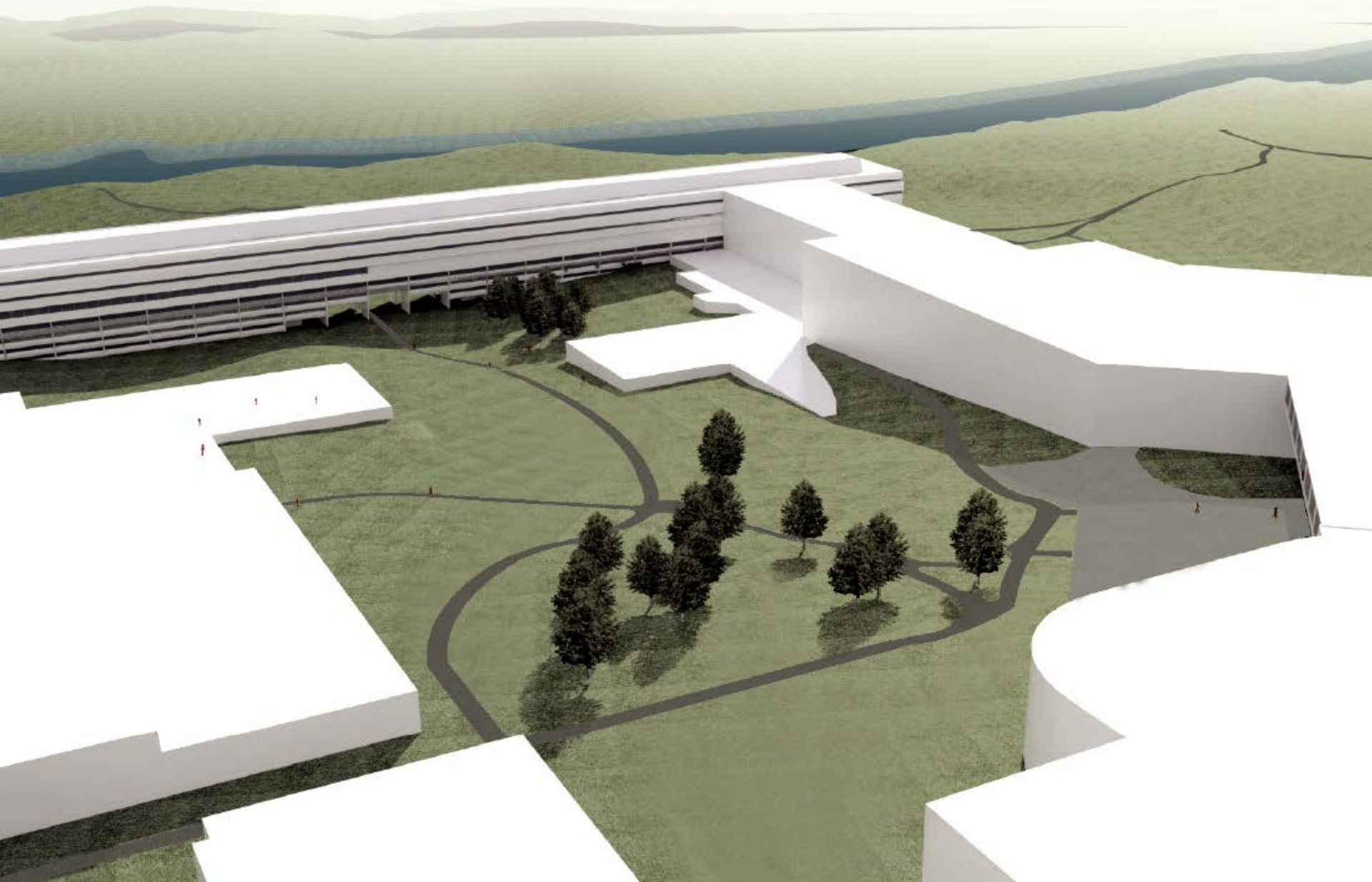

Option A: North-east view of University Hall from proposed Bridge

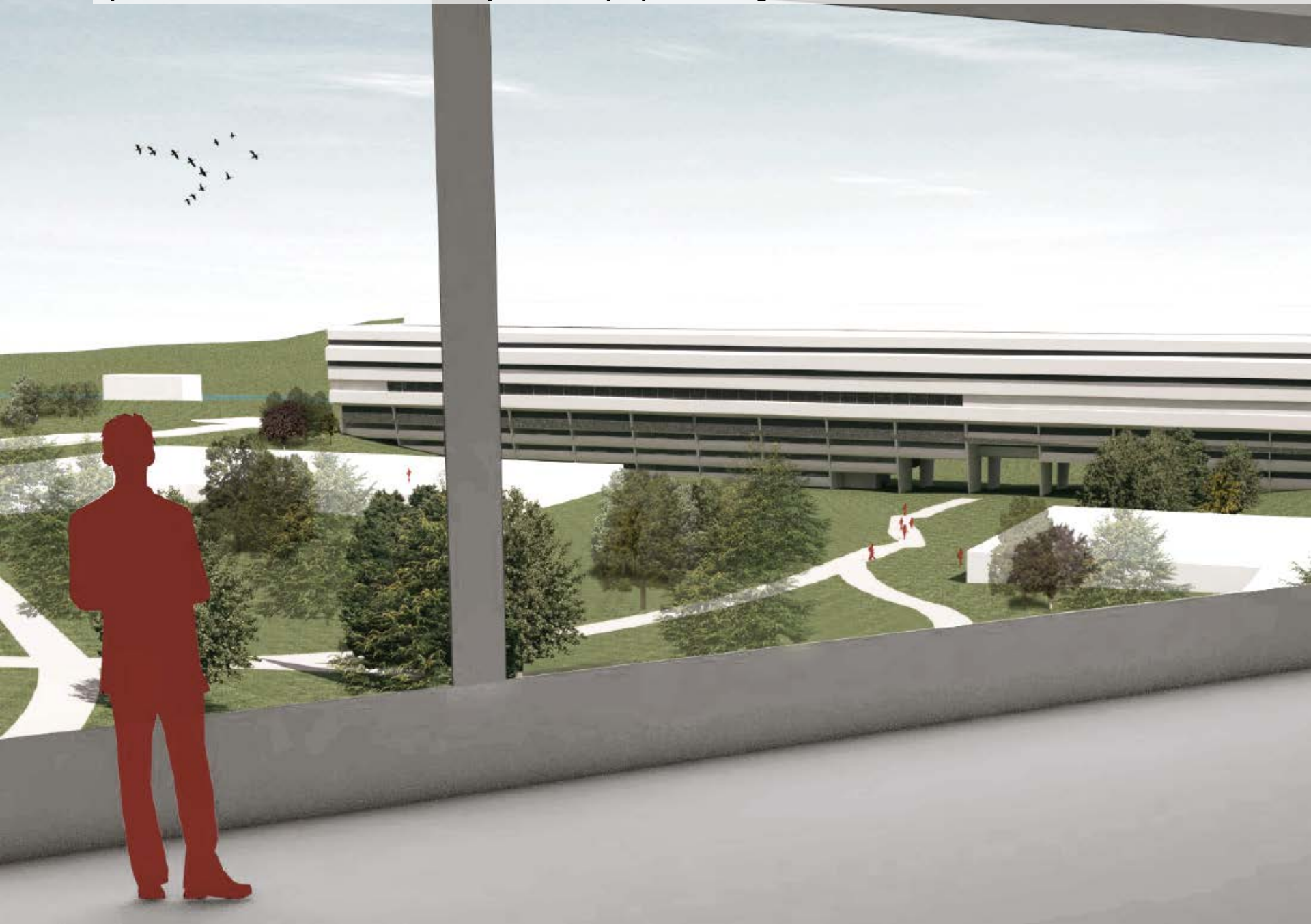

Option A: North-east view from roof deck of proposed Building embedded along coulee edge at Aperture Drive



Option A: View looking towards proposed Bridge and Aperture Drive from Coulee-Quad



Option A:

The Campus in the Future: An Integrated Campus for a Comprehensive Institution

Proposed Buildings



Quad/Plaza Frontage



Building Type

- Academic (Proposed)
- Residential (Proposed)



Building Height (No. of Storeys)

- 1 Storey
- 2 Storeys
- 3 Storeys
- 4 Storeys
- 5 Storeys



Gross Floor Areas

- | | | |
|--------------|--------------|---------------|
| 1 1,450 GSM | 6 6,036 GSM | 8 7,040 GSM |
| 2 3,604 GSM | 7 5,800 GSM | 9 20,000 GSM |
| 3 23,079 GSM | 8 7,818 GSM | 10 9,395 GSM |
| 4 5,560 GSM | 9 16,075 GSM | 11 4,590 GSM |
| 5 11,622 GSM | 10 5,440 GSM | 12 4,680 GSM |
| 6 7,305 GSM | 11 5,440 GSM | 13 3,660 GSM |
| 7 6,425 GSM | 12 5,440 GSM | 14 14,250 GSM |

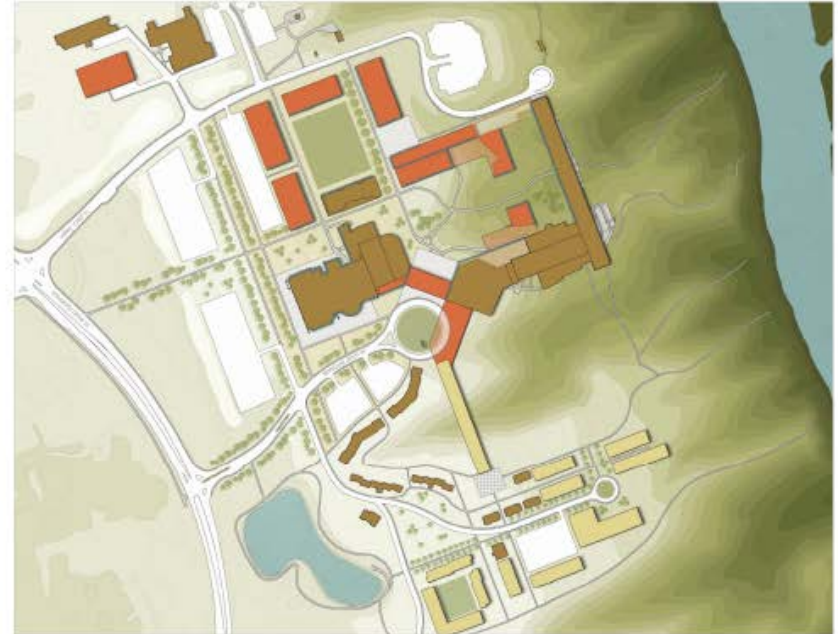

- Existing Buildings
- Proposed Renovations/Additions
- Proposed Academic/Research Buildings
- Proposed Residential Buildings
- Proposed Upper Level Connections
- Quad/Plaza Frontage

Option A: Proposed Buildings

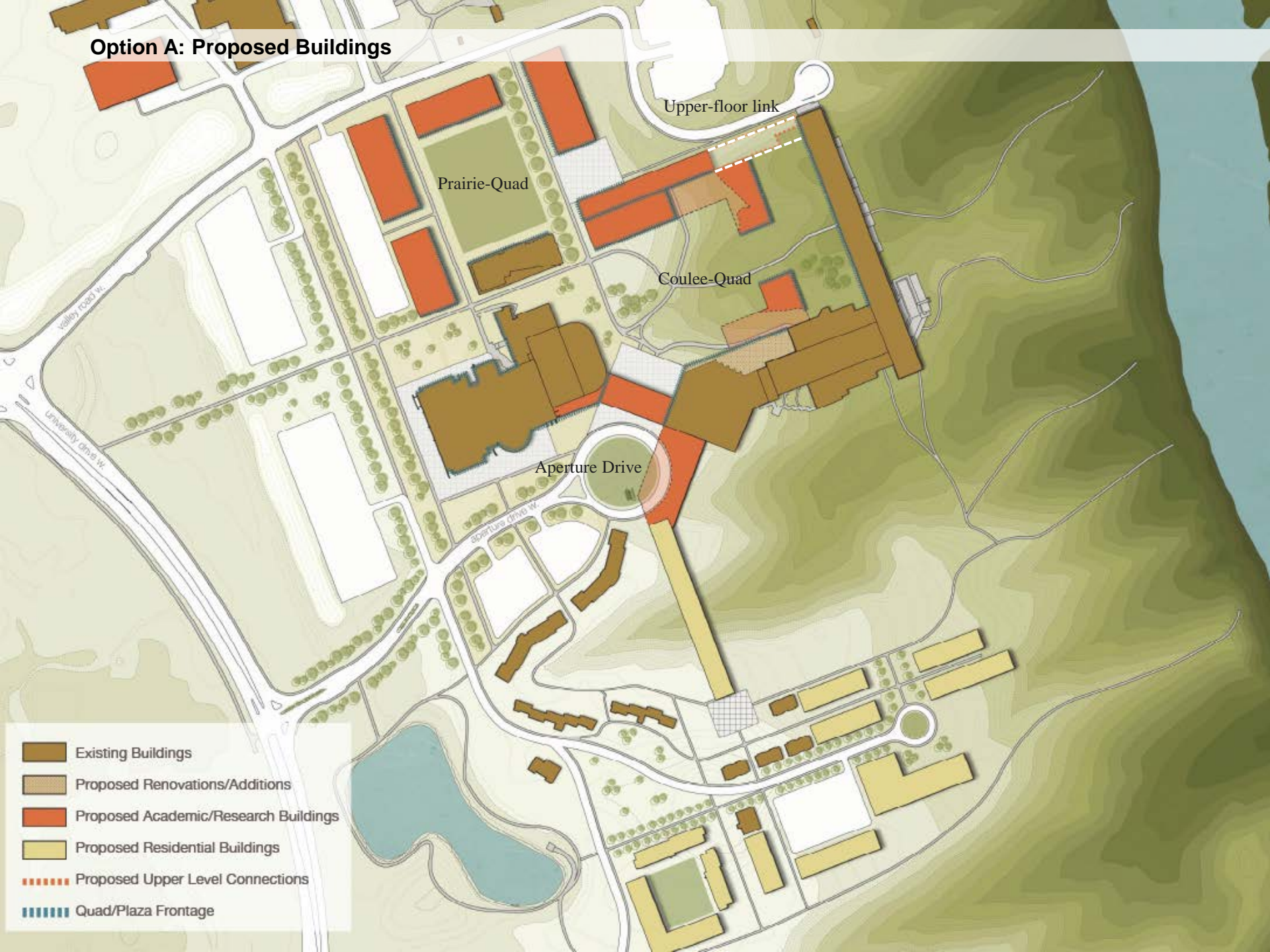

Option A:

The Campus in the Future: An Integrated Campus for a Comprehensive Institution

Creating a Pedestrian-Oriented Campus: Prioritizing Proximity and Walkability

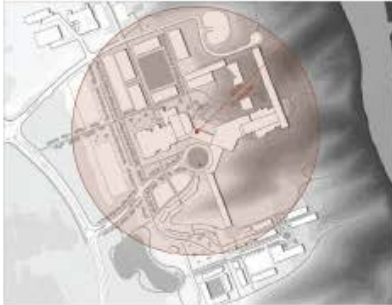

10 minute walking circle
(Time could vary depending on terrain)

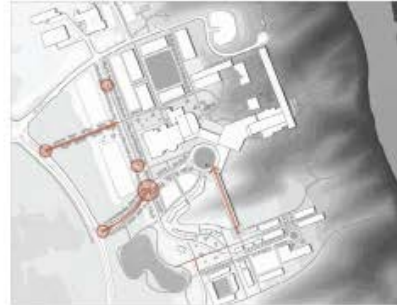

Campus Arrival
● Gateways
■ Primary Approaches

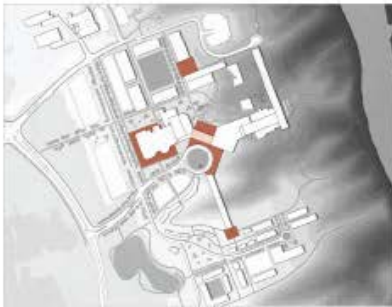

Pedestrian Plazas
■ Plazas
■ Covered Plazas



Pedestrian Path Network
— Exterior Pedestrian Circulation
- - - Interior Pedestrian Circulation



● Gateways
— Exterior Pedestrian Circulation
- - - Interior Pedestrian Circulation
■ Pedestrian Plazas

Option A: Pedestrian Network

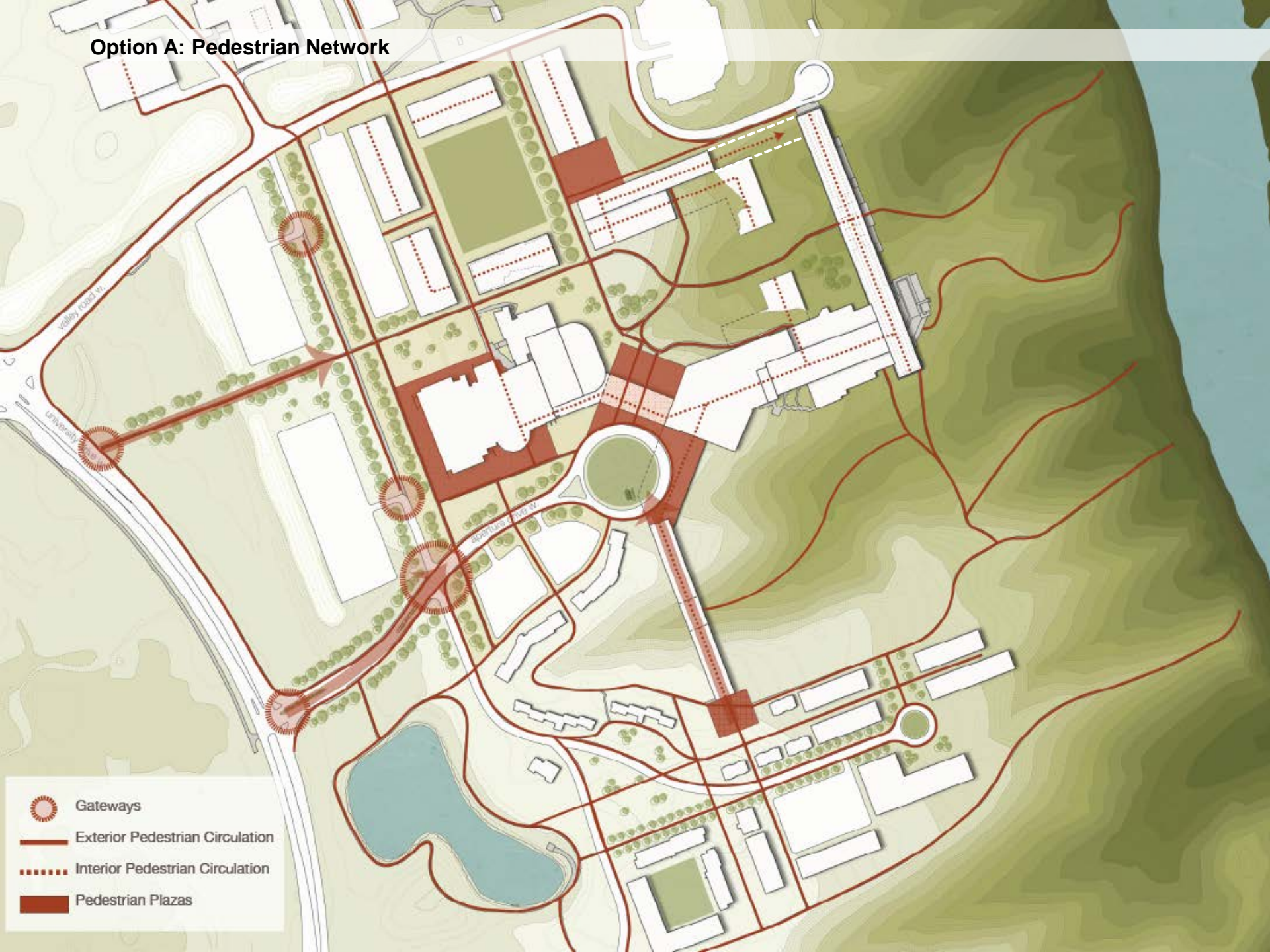

Gateways

Exterior Pedestrian Circulation

Interior Pedestrian Circulation

Pedestrian Plazas

Option A: Proximity

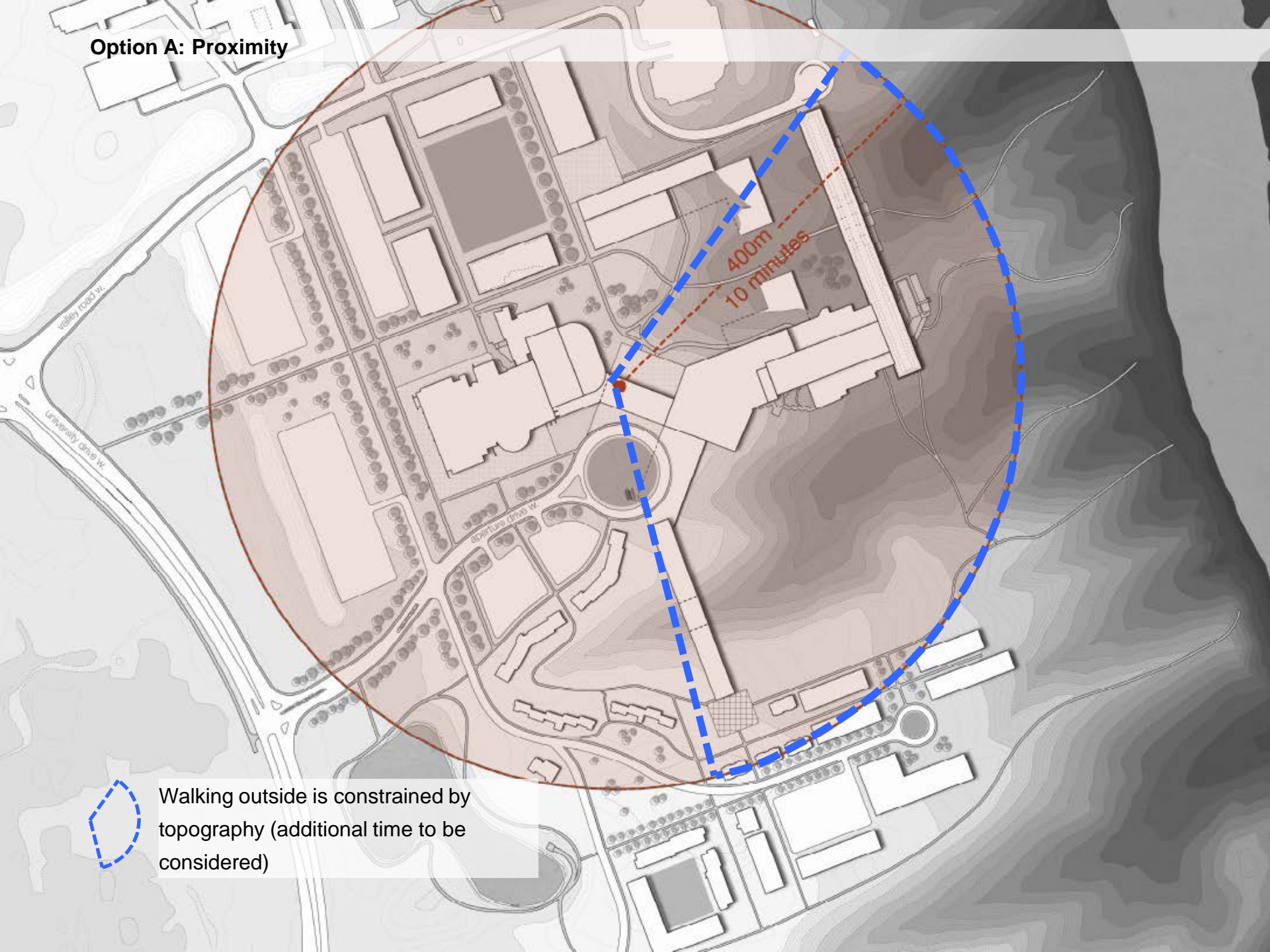

Walking outside is constrained by topography (additional time to be considered)

Option A:

The Campus in the Future: An Integrated Campus for a Comprehensive Institution

Vehicular Circulation



Campus Arrival

- Gateway
- Primary Approach



Vehicular Circulation

- Vehicular Circulation
- Parking



- Gateway
- Vehicular Circulation
- Transit Route
- Service Route
- Emergency Route
- Parking



Access Routes

- Service Route
- Emergency Route



Transit Route

Option A: Vehicular Network



Gateway



Vehicular Circulation



Transit Route



Service Route



Emergency Route



Parking

Option A:

The Campus in the Future: An Integrated Campus for a Comprehensive Institution

Reinforcing the presence of the
Campus within its natural setting



Prairie Quad



Coulee Quad



Primary Views

- Views
- Pedestrian Circulation
- Pedestrian Plazas



Additional Landscape Initiatives:

- Parkland
- Bioswale
- Trail Corridors

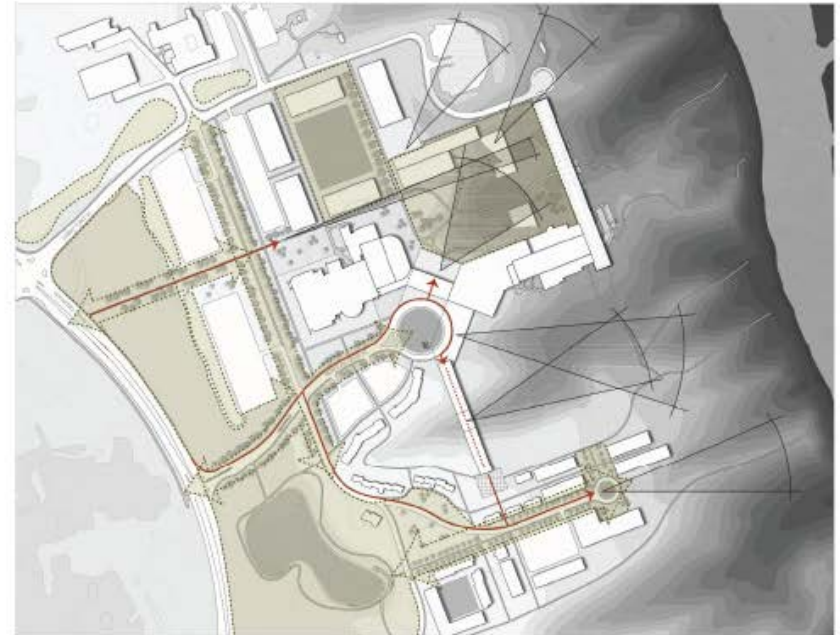

- Primary Views
- Landscape Initiatives
- Pedestrian Circulation

Option A: Views

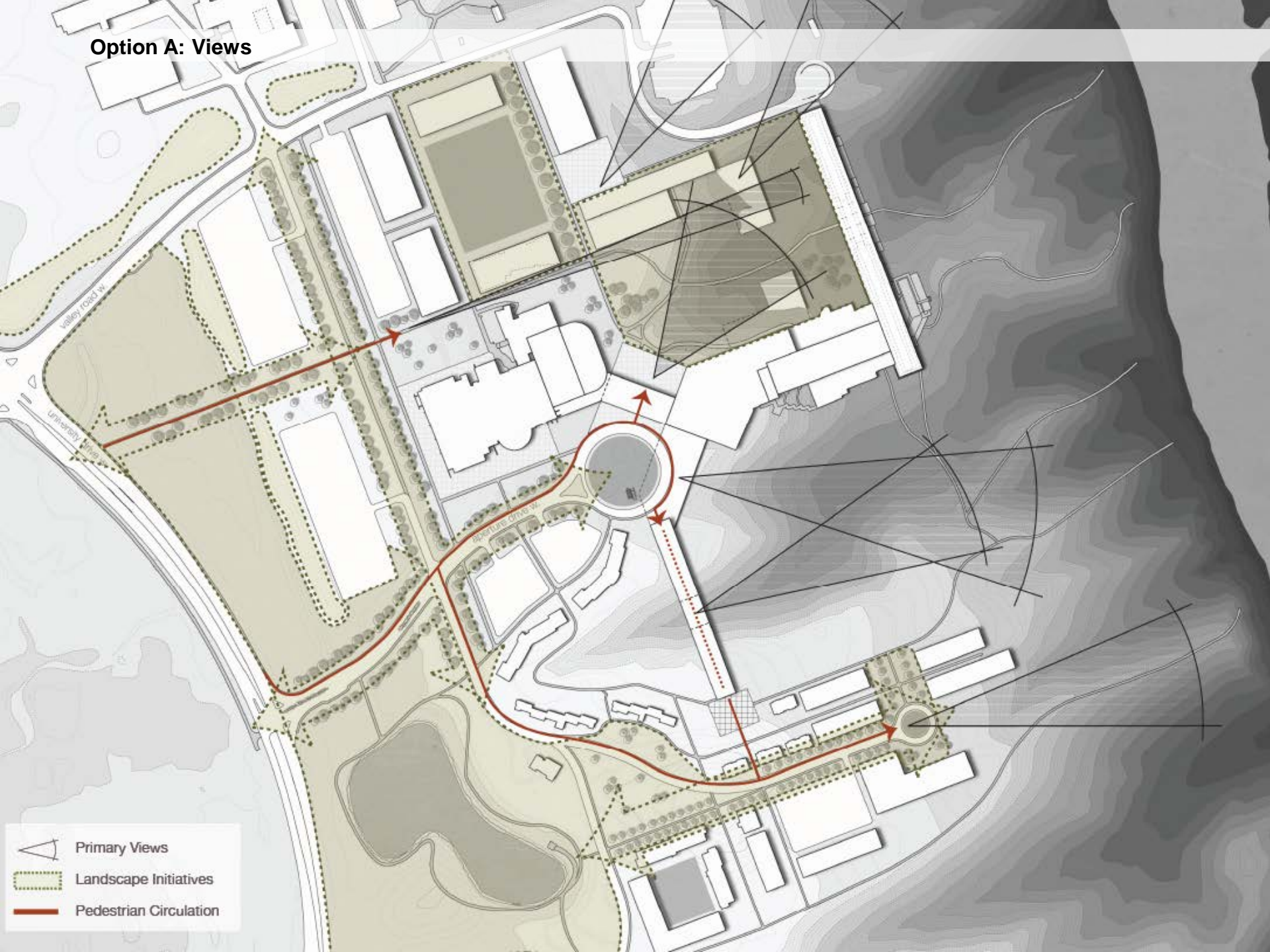

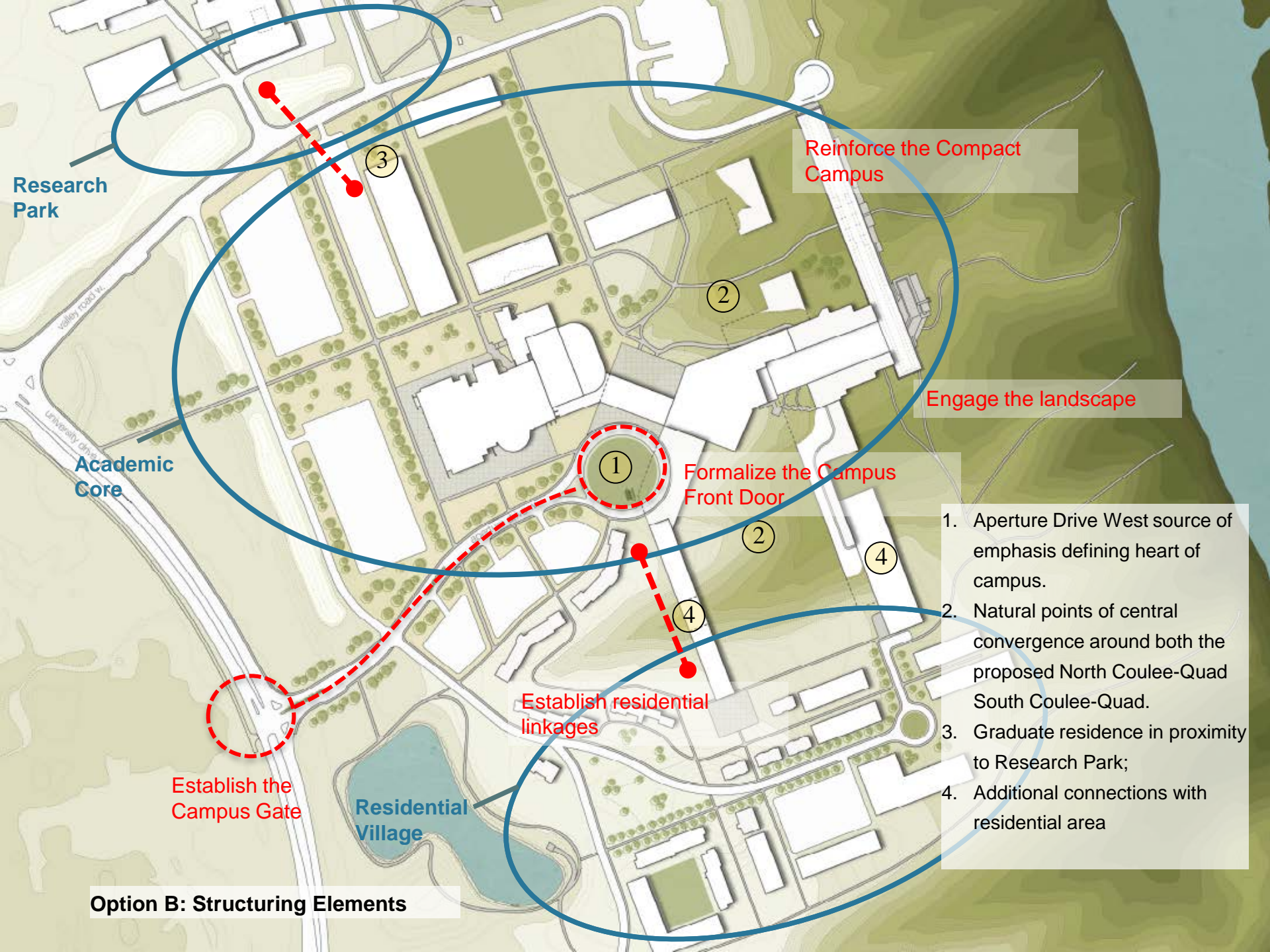

Research Park

Reinforce the Compact Campus

Engage the landscape

Academic Core

Formalize the Campus Front Door

Establish the Campus Gate

Establish residential linkages

Residential Village

- 1. Aperture Drive West source of emphasis defining heart of campus.
- 2. Natural points of central convergence around both the proposed North Coulee-Quad South Coulee-Quad.
- 3. Graduate residence in proximity to Research Park;
- 4. Additional connections with residential area

Option B: Structuring Elements

Option B:

The Campus in the Future

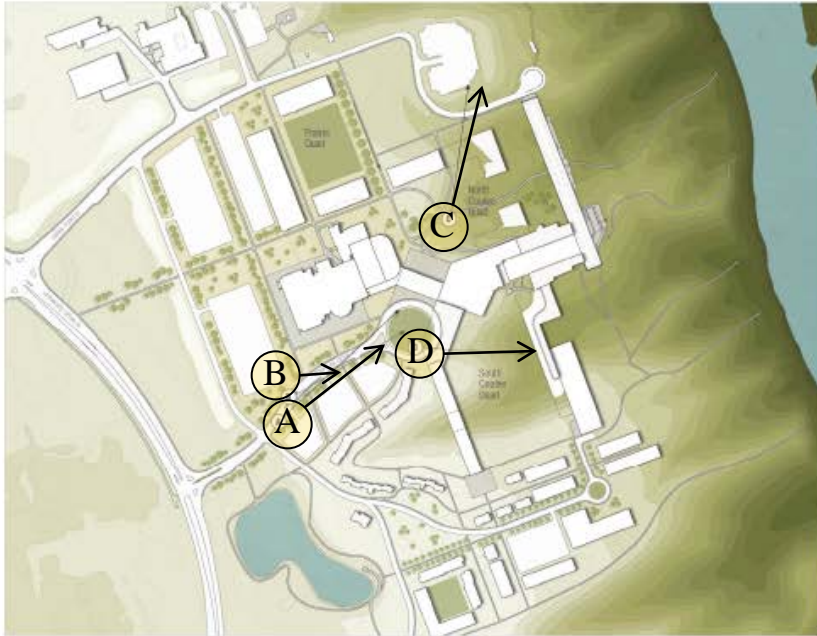

Option B:

Aperture Drive West will regain its original source of emphasis and define a new heart of campus. This will help identify a visible and natural point of convergence around both the proposed North Coulee-quad and South Coulee-quad where students, faculty and staff will meet, socialize and access key services. The location of this core will help re-calibrate the campus and will concentrate services and amenities to create the kind of density that attracts people and makes them want to spend time on campus.

Option B: View along Aperture Drive towards proposed Bridge



Option B: Bird's eye view along Aperture Drive



Option B: East view from roof deck of proposed Building embedded along coulee edge at Aperture Drive

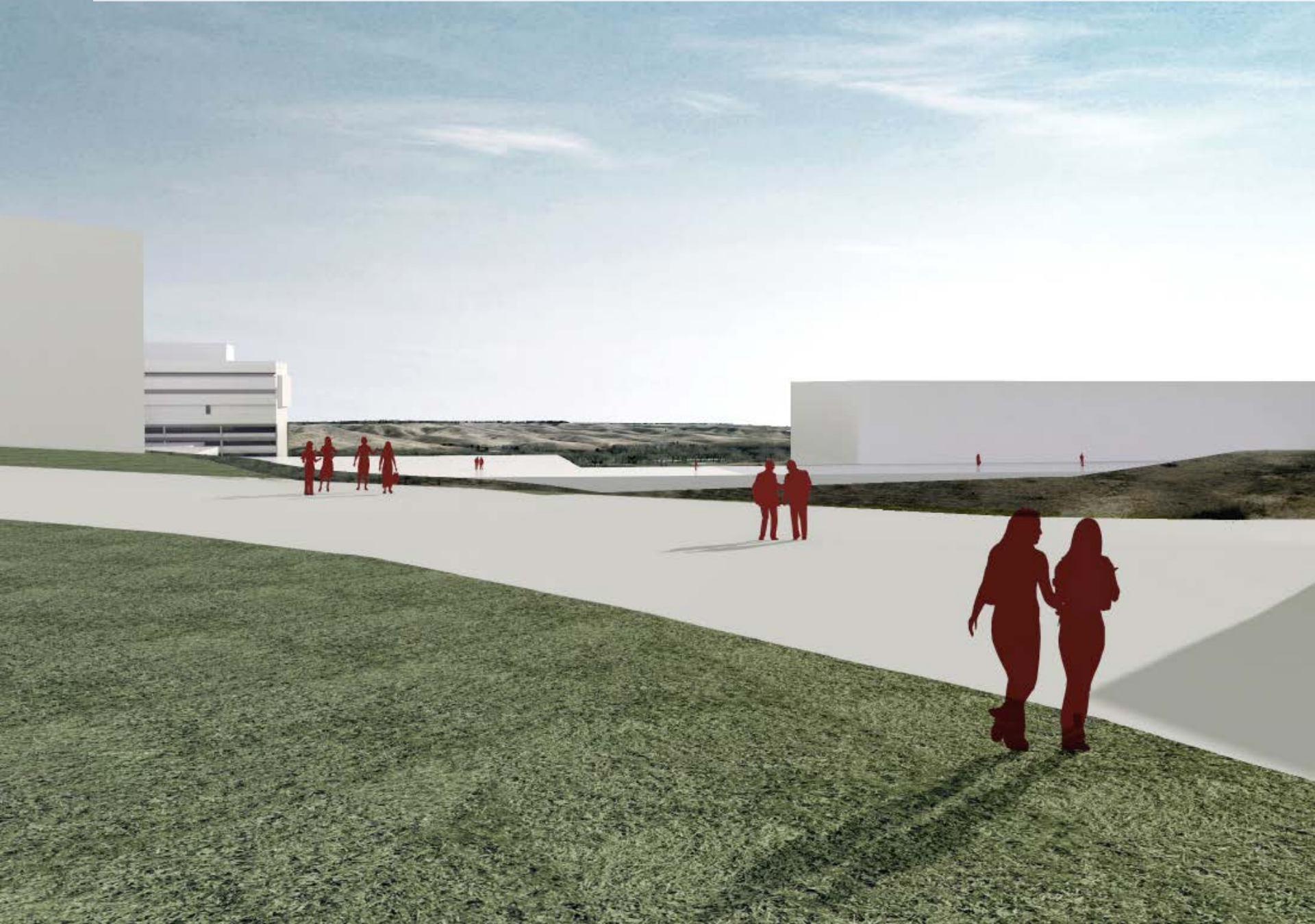

Option B: North-east view towards historic Viaduct from Coulee-Quad



Option B:

The Campus in the Future: An Integrated Campus for a Comprehensive Institution

Proposed Buildings



Quad/Plaza Frontage

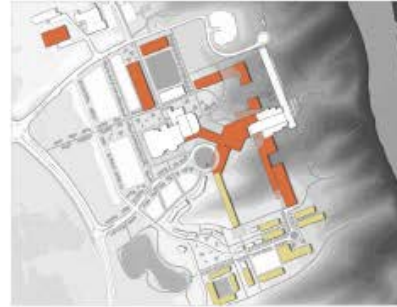

Building Type

- Academic (Proposed)
- Residential (Proposed)

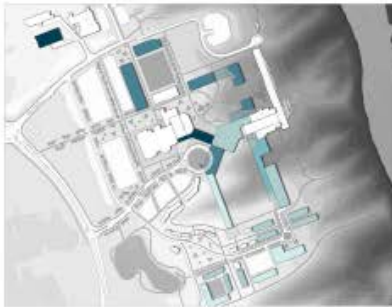

Building Height (No. of Storeys)

- 1 Storey
- 2 Storeys
- 3 Storeys
- 4 Storeys
- 5 Storeys

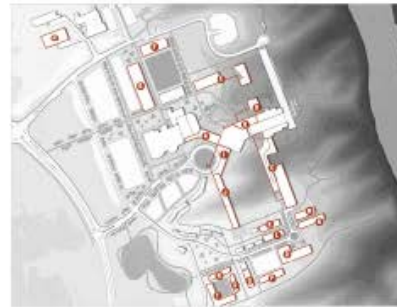

Gross Floor Areas

- | | | |
|--------------|--------------|---------------|
| 1 1,450 GSM | 6 5,800 GSM | 11 20,000 GSM |
| 2 3,604 GSM | 7 7,818 GSM | 12 9,385 GSM |
| 3 39,095 GSM | 8 18,075 GSM | 13 4,580 GSM |
| 4 5,390 GSM | 9 5,440 GSM | 14 4,680 GSM |
| 5 14,690 GSM | 10 5,440 GSM | 15 3,600 GSM |
| 6 7,305 GSM | 11 5,440 GSM | 16 14,250 GSM |
| 7 8,424 GSM | 12 7,040 GSM | |

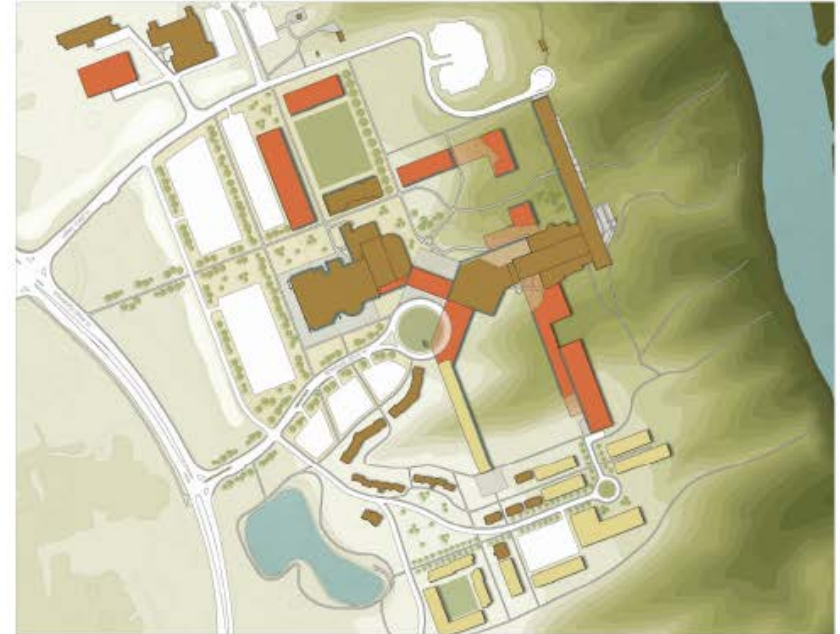

- Existing Buildings
- Proposed Renovations/Additions
- Proposed Academic/Research Buildings
- Proposed Residential Buildings
- Proposed Upper Level Connections
- Quad/Plaza Frontage

Option B: Proposed Buildings

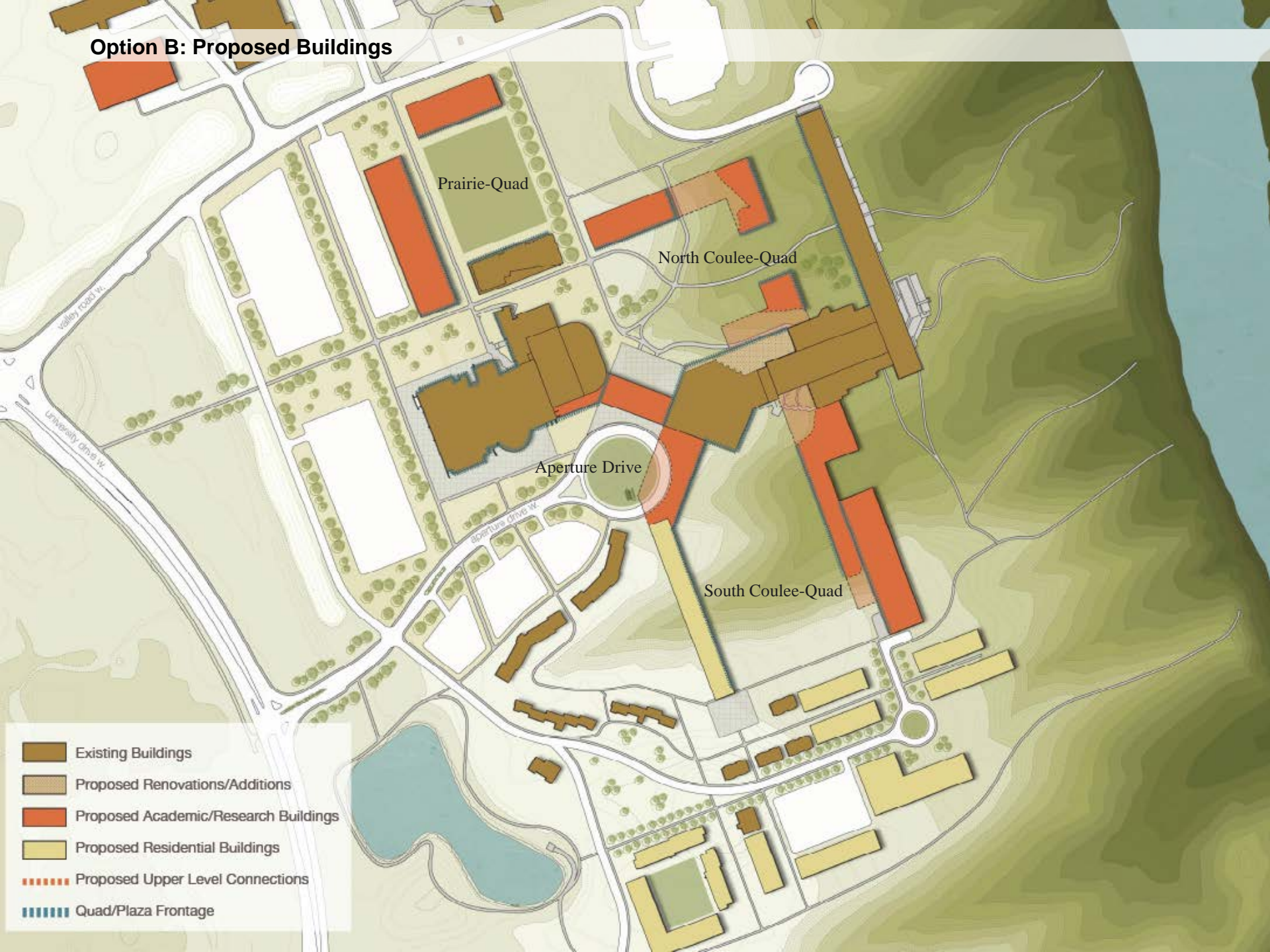

- Existing Buildings
- Proposed Renovations/Additions
- Proposed Academic/Research Buildings
- Proposed Residential Buildings
- Proposed Upper Level Connections
- Quad/Plaza Frontage

Option B:

The Campus in the Future: An Integrated Campus for a Comprehensive Institution

Creating a Pedestrian-Oriented Campus: Prioritizing Proximity and Walkability

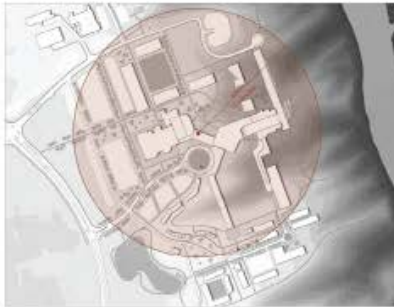

10 minute walking circle
(Time could vary depending on terrain)

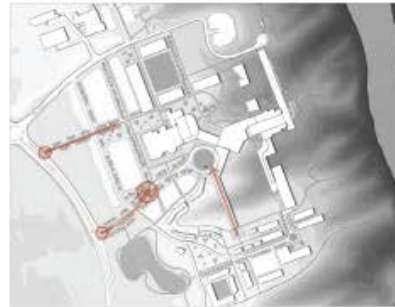

Campus Arrival

- Gateways
- Primary Approaches

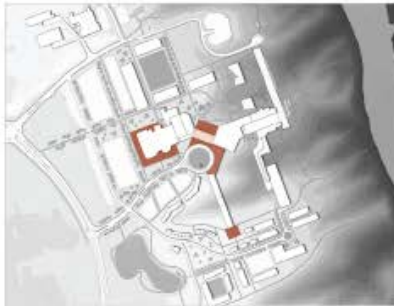

Pedestrian Plazas

- Plazas
- Covered Plazas



Pedestrian Path Network

- Exterior Pedestrian Circulation
- Interior Pedestrian Circulation



- Gateways
- Exterior Pedestrian Circulation
- Interior Pedestrian Circulation
- Pedestrian Plazas

Option B: Pedestrian Network

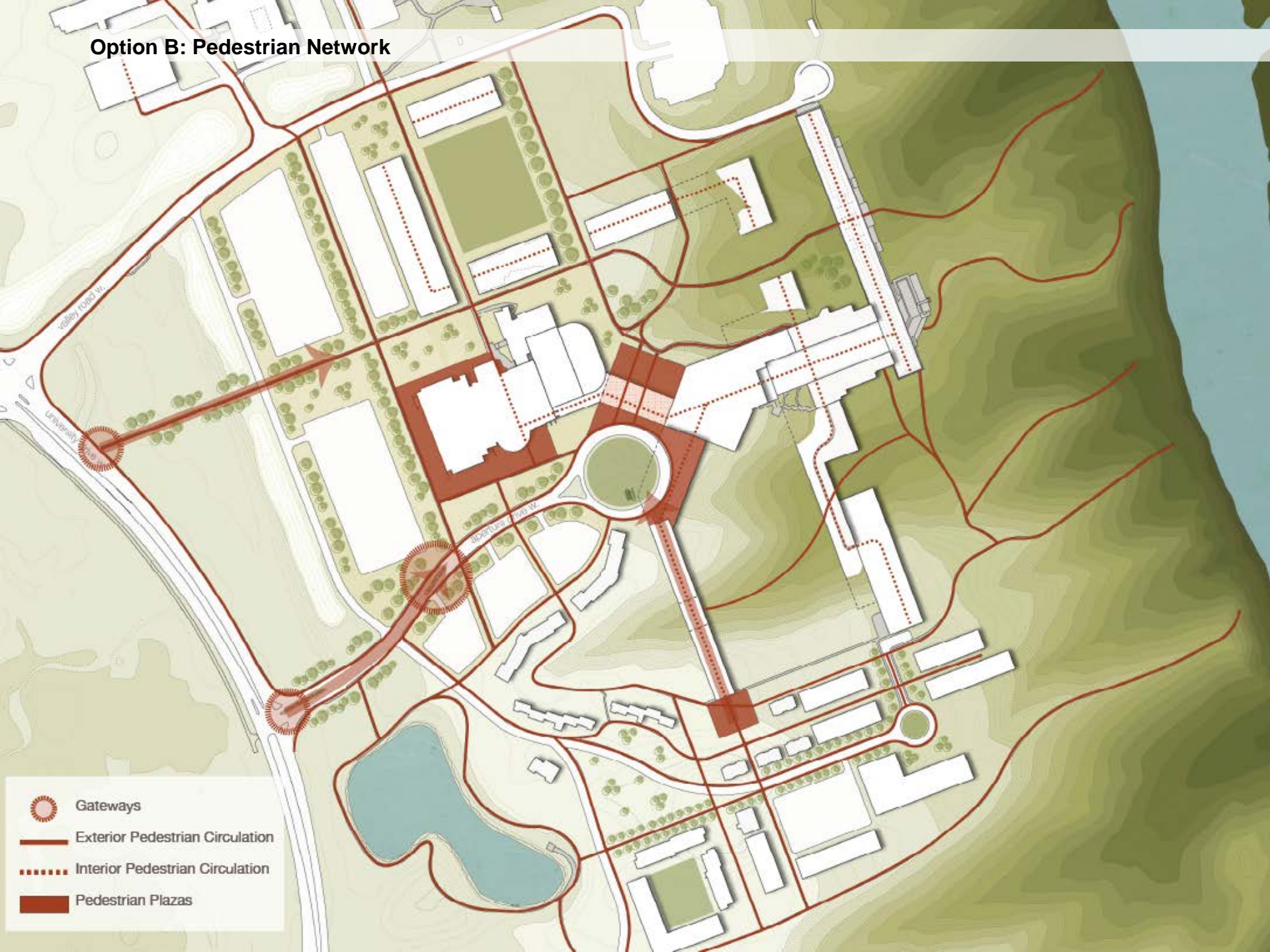

Option B: Pedestrian Network

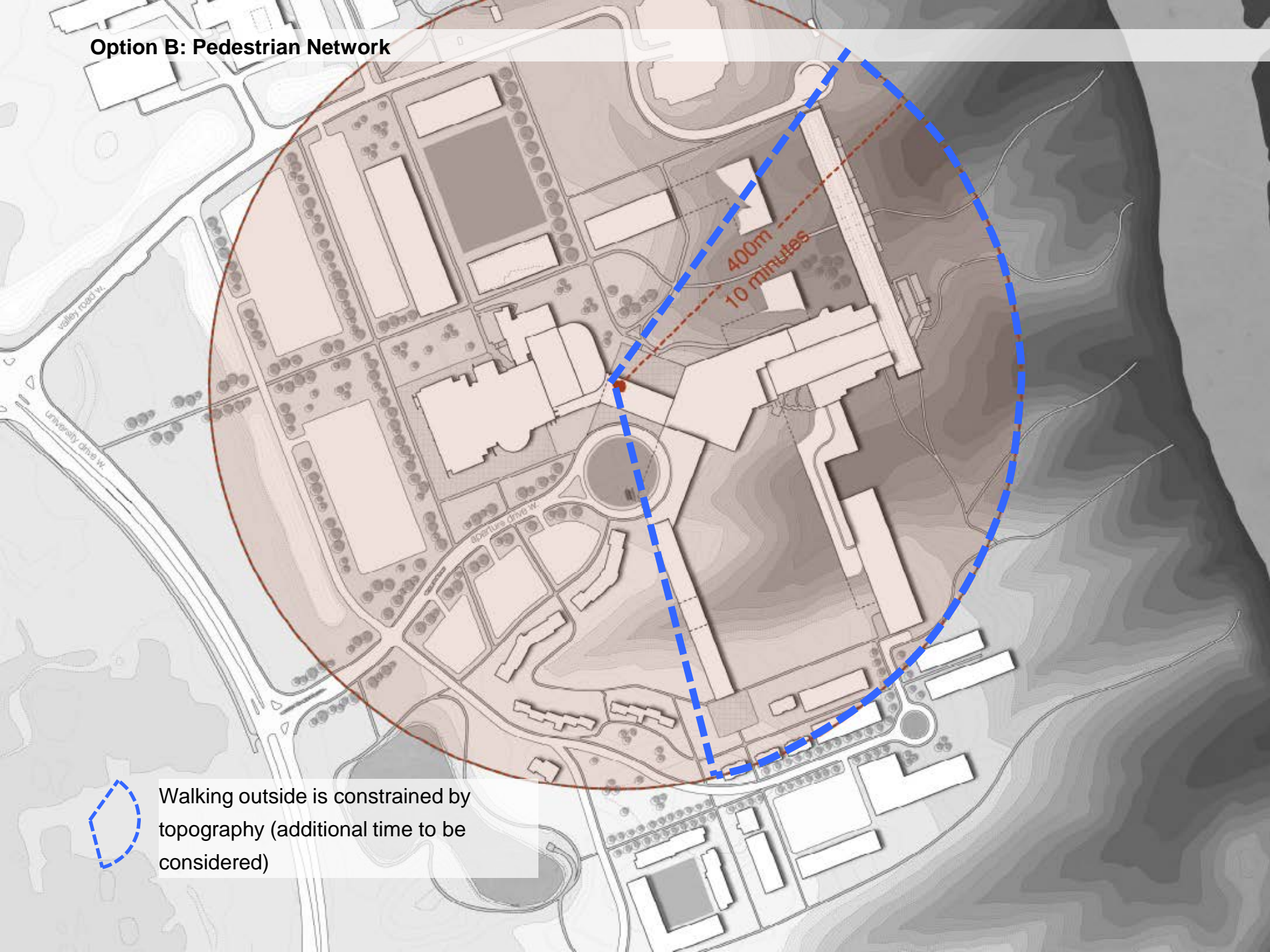

Walking outside is constrained by topography (additional time to be considered)

Option B:

The Campus in the Future: An Integrated Campus for a Comprehensive Institution

Vehicular Circulation



Campus Arrival

- Gateway
- Primary Approach



Vehicular Circulation

- Vehicular Circulation
- Parking

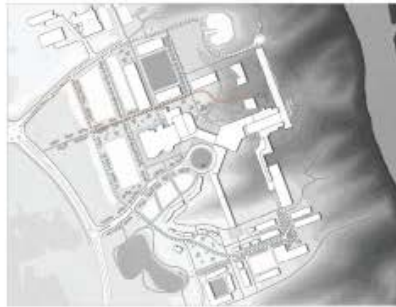

Access Routes

- Service Route
- Emergency Route

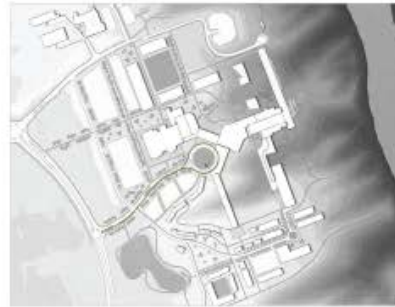

Transit Route



- Gateway
- Vehicular Circulation
- Transit Route
- Service Route
- Emergency Route
- Parking

Option B: Vehicular Network



Gateway

Vehicular Circulation

Transit Route

Service Route

Emergency Route

Parking

Option B:

The Campus in the Future: An Integrated Campus for a Comprehensive Institution

Reinforcing the presence of the
Campus within its natural setting

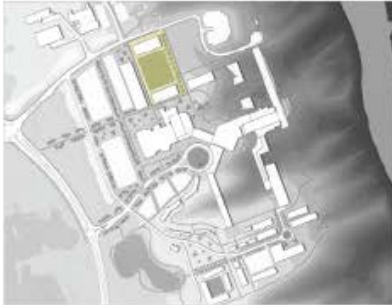

Prairie Quad



Coulee Quad



Primary Views



Additional Landscape Initiatives:

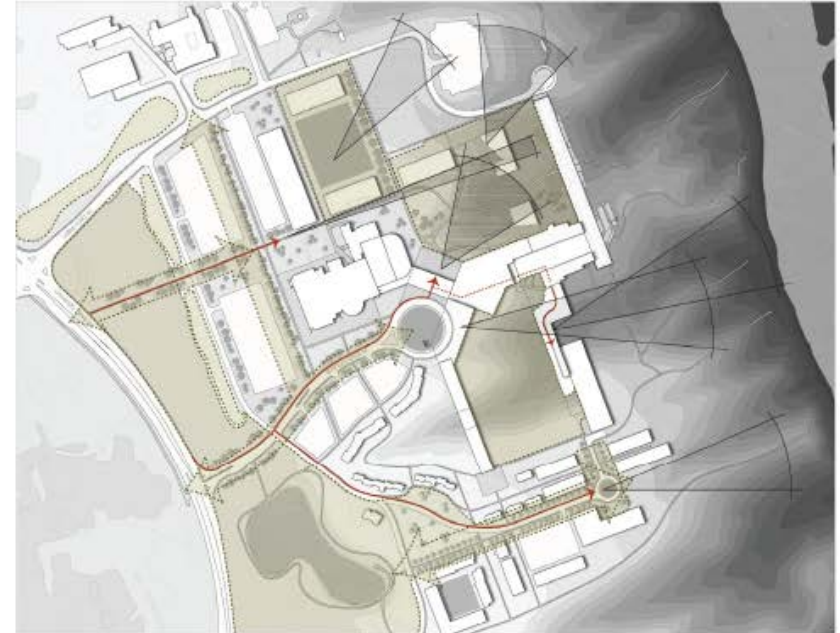

- Primary Views
- Landscape Initiatives
- Pedestrian Circulation

- Views
- Pedestrian Circulation
- Pedestrian Plazas

- Parkland
- Bioscience
- Trained Corridors

Option B: Views

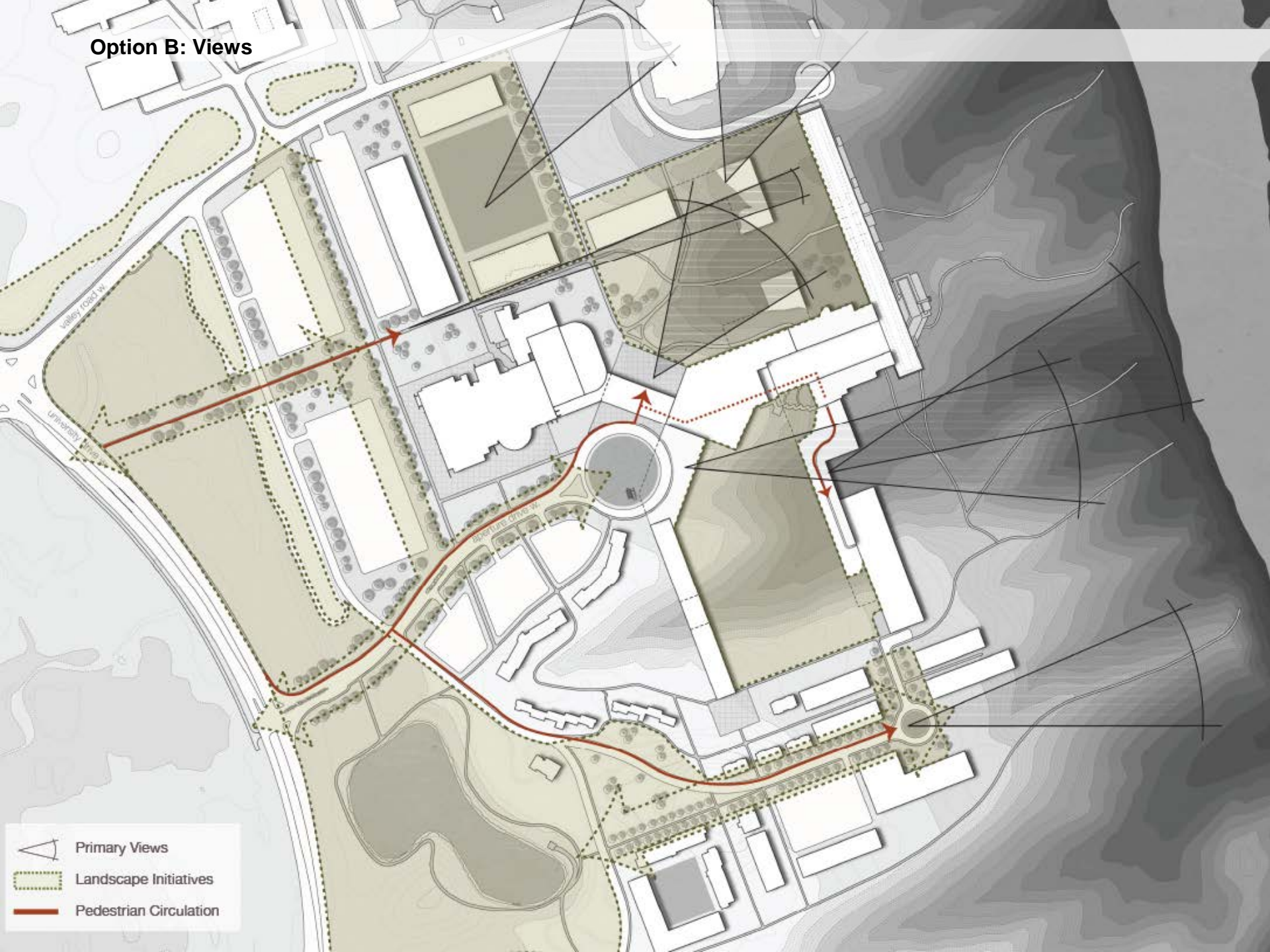

Option A and Option B:

Summary



1. Which Option better shows how physical and programmatic linkages between University Hall and the rest of campus have been strengthened?
2. Which Option better locates a new campus heart with regards to accessible services and amenities -- a plan that would incentivize people to spend time on campus?
3. Which Option would better establish better, more viable connections to the existing and proposed residential areas?
4. Which Option better celebrates and respects the surrounding coulee setting?