

Have you ever wondered where your family homestead was in Southern Alberta?

Maybe you'll find their name on one of these old maps.

Alberta Homestead Maps - circa 1918

General Areas Covered on Each Map in #16 of 1918 Series:

Map #35 - Township 11 & 12 — Range 13, 14 & 15 — north of Grassy Lake & Purple Springs

Map #35A - Township 13 & 14 — Range 13, 14 & 15 — Armelgra, Scope, Grantham

Map #36 - Township 11 & 12 — Range 16, 17 & 18 — north of Taber

Map #36A - Township 13 & 14 — Range 16, 17 & 18 — Vauxhall, Retlaw, Enchant

Credit: Cummins Rural Directory Map

Would you like to see what the area looks like today?

Any parcel of land in Alberta can be located by its legal land description which is based on the Alberta Township Survey system. It is a grid network dividing the province into equal-sized parcels of land.

On a side column of the map you will find the Township (Tp) number.

Provide us with the **township number** (on the side column) and the **range number** (R - on the bottom of the map) **along with the name you are interested in.**

Send a check for \$30 U.S. (\$35 Can.) and \$10 U.S. \$12 Can.) for each additional name to:

Historical Research Centre

1115- 8 Ave. S.

Lethbridge, Alberta, Canada T1J1P7

Phone 403 328 3824

We will send you in jpeg form: (or hard copy if you prefer snail mail)

1 —A topographical map view of the area.

2 —A google earth view from space of the area today

3— Directions on how to reach the site

Check out the next page to see an example.

Here is an example of what you get:

Let's say you wanted to find the site of the old Pearce Air Base where air crew from across the British Commonwealth were trained during World War II.

Once you tell us the township and the range numbers we will send you the following in jpeg form. (or hard copy if you prefer snail mail)

1 — A topographical map view of the area.



2 — A google earth view from space of the area today



3 — Directions on how to reach the site

Start address:	49.633686, -112.791309 +49° 38' 1.27", -112° 47' 28.71"
End address:	49.834970, -113.253753 +49° 50' 5.89", -113° 15' 13.51"
Distance:	30.6 mi (about 39 mins)

[Reverse directions](#)

1. Head **east** - go **0.2 mi**
2. Turn **left** at **HWY-5** - go **1.5 mi**
3. Continue on **Mayor Magrath Dr S** - go **2.9 mi**
4. Take the **HWY-3 ramp to Ft MacLeod/Calgary/Medicine Hat** - go **455 ft**
5. Take the **HWY-3 W ramp to Ft MacLeod/Calgary** - go **23 mi**
6. Turn **right** at **Range Road 250** - go **3.4 mi**
7. Arrive at **49.834970, -113.253753**
+49° 50' 5.89", -113° 15' 13.51"

A map showing the route from the start address to the end address. The route is highlighted in blue and yellow. It starts near Fort MacLeod, goes east on HWY-5, then south on Mayor Magrath Dr S, then west on HWY-3, and finally south on Range Road 250. The route passes through Coalhurst and Lethbridge. The map includes a compass rose and a scale bar.

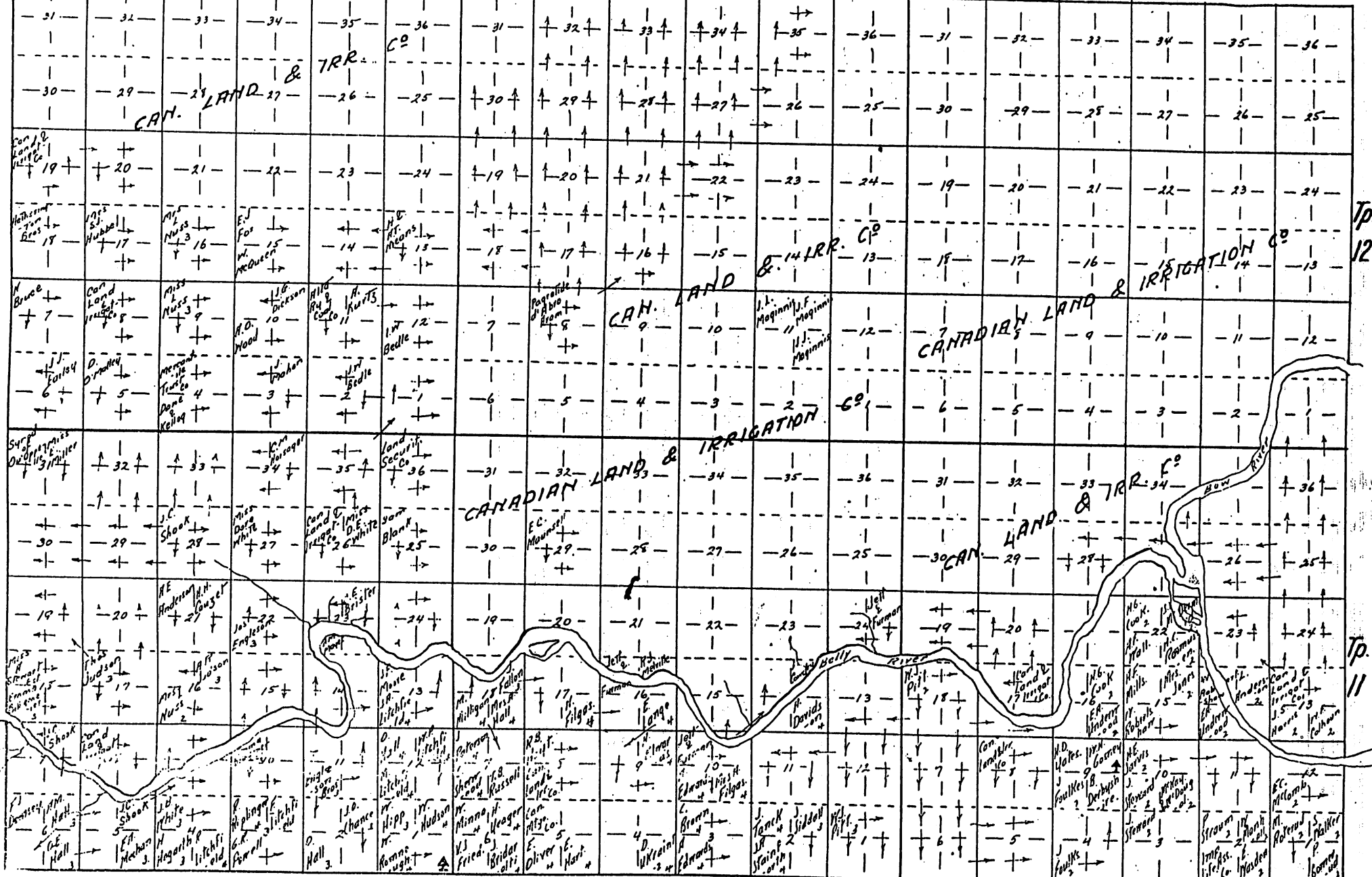

R.15.

1. MEDICINE HAT
2. GRASSY LAKE

3. FABER
4. PURPLE SPRINGS.

R.14 W. of 4th M.

R.13 CUMMINGS MAP CO. N°35
WINNIPEG, MAN.

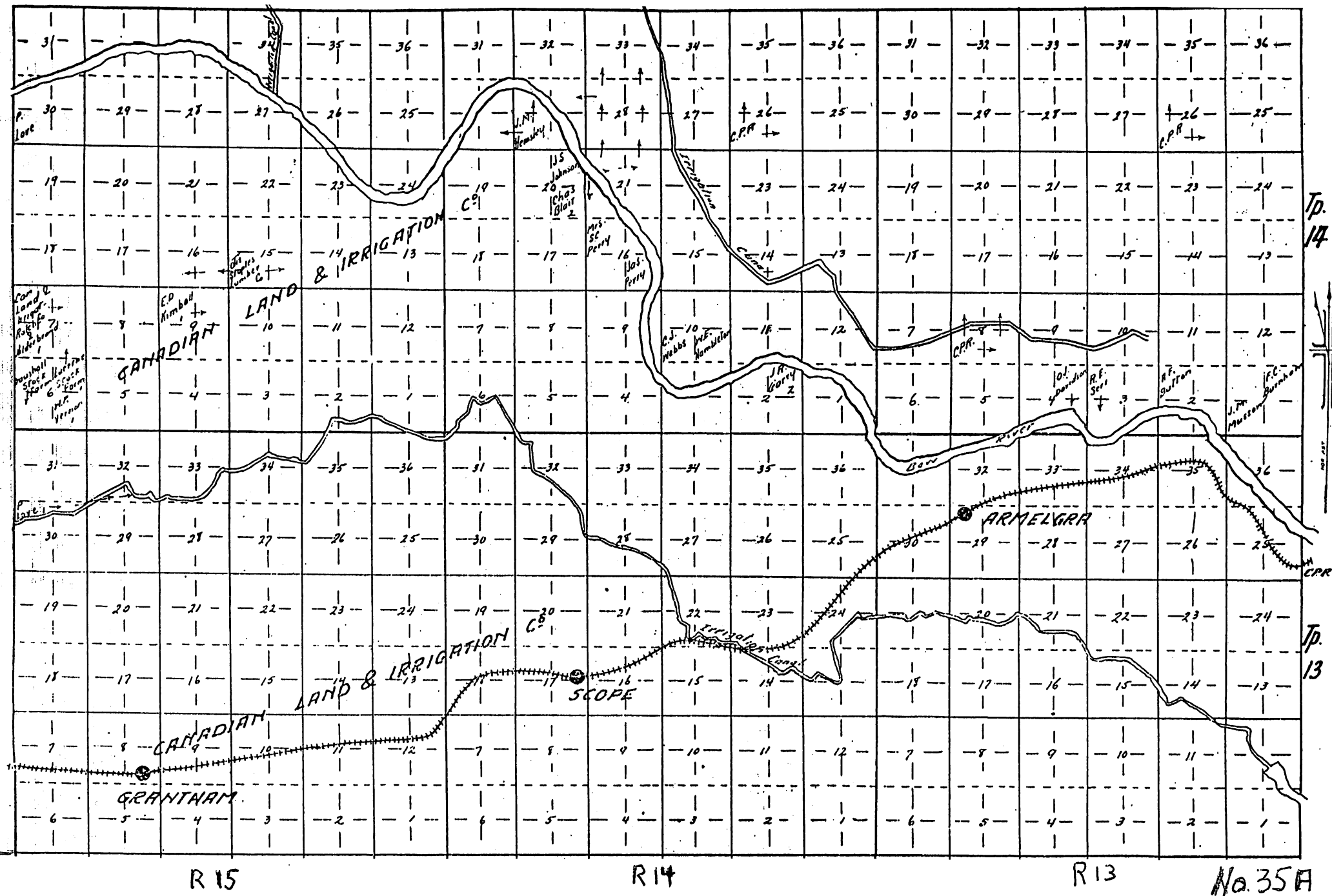

1 LINCHNANT
2 KELLAW
3 INBER

R.18 A NOBLEFORD
5 RIVERBON
6 LOST LAKE

R.17 W. of 4th M.

R.16 Cummins Map Co. No 36
REGINA, SASK.

13. NOBLE FOUNDATION

14. CANADA LAND & IRRIGATION CO.

15. ALBERTA

16. ALBERTA

17. ALBERTA

18. ALBERTA

19. ALBERTA

20. ALBERTA

21. ALBERTA

22. ALBERTA

23. ALBERTA

24. ALBERTA

25. ALBERTA

26. ALBERTA

27. ALBERTA

28. ALBERTA

29. ALBERTA

30. ALBERTA

31. ALBERTA

32. ALBERTA

33. ALBERTA

34. ALBERTA

35. ALBERTA

36. ALBERTA

37. ALBERTA

38. ALBERTA

39. ALBERTA

40. ALBERTA

41. ALBERTA

42. ALBERTA

43. ALBERTA

44. ALBERTA

45. ALBERTA

46. ALBERTA

47. ALBERTA

48. ALBERTA

49. ALBERTA

50. ALBERTA

51. ALBERTA

52. ALBERTA

53. ALBERTA

54. ALBERTA

55. ALBERTA

56. ALBERTA

57. ALBERTA

58. ALBERTA

59. ALBERTA

60. ALBERTA

61. ALBERTA

62. ALBERTA

63. ALBERTA

64. ALBERTA

65. ALBERTA

66. ALBERTA

67. ALBERTA

68. ALBERTA

69. ALBERTA

70. ALBERTA

71. ALBERTA

72. ALBERTA

73. ALBERTA

74. ALBERTA

75. ALBERTA

76. ALBERTA

77. ALBERTA

78. ALBERTA

79. ALBERTA

80. ALBERTA

81. ALBERTA

82. ALBERTA

83. ALBERTA

84. ALBERTA

85. ALBERTA

86. ALBERTA

87. ALBERTA

88. ALBERTA

89. ALBERTA

90. ALBERTA

91. ALBERTA

92. ALBERTA

93. ALBERTA

94. ALBERTA

95. ALBERTA

96. ALBERTA

97. ALBERTA

98. ALBERTA

99. ALBERTA

100. ALBERTA

