

Have you ever wondered where your family homestead was in Southern Alberta?

Maybe you'll find their name on one of these old maps.

Alberta Homestead Maps - circa 1918

General Areas Covered on Each Map in #15 of 1918 Series:

Map #33 - Township 11 & 12— Range 7, 8 & 9 — Whitla, Winnifred & north

Map #33A - Township 13 & 14 — Range 7, 8 & 9 — Stair, Bowell, Dennis, Suffield

Map #34 - Township 11 & 12 — Range 10, 11 & 12 — Inversnay, north of Bow Island

Map #34A - Township 13 & 14 — Range 10, 11 & 12 — Agatha, Illingsworth, Ronalane, Terrace

Credit: Cummins Rural Directory Map

Would you like to see what the area looks like today?

Any parcel of land in Alberta can be located by its legal land description which is based on the Alberta Township Survey system. It is a grid network dividing the province into equal-sized parcels of land.

On a side column of the map you will find the Township (Tp) number.

Provide us with the **township number** (on the side column) and the **range number** (R - on the bottom of the map) **along with the name you are interested in.**

Send a check for \$30 U.S. (\$35 Can.) and \$10 U.S. \$12 Can.) for each additional name to:

Historical Research Centre

1115- 8 Ave. S.

Lethbridge, Alberta, Canada T1J1P7

Phone 403 328 3824

We will send you in jpeg form: (or hard copy if you prefer snail mail)

- 1 —A topographical map view of the area.**
- 2 —A google earth view from space of the area today**
- 3— Directions on how to reach the site**

Check out the next page to see an example.

Here is an example of what you get:

Let's say you wanted to find the site of the old Pearce Air Base where air crew from across the British Commonwealth were trained during World War II.

Once you tell us the township and the range numbers we will send you the following in jpeg form. (or hard copy if you prefer snail mail)

1 – A topographical map view of the area.



2 – A google earth view from space of the area today



3 – Directions on how to reach the site

Start address:	49.633686, -112.791309 +49° 38' 1.27", -112° 47' 28.71"
End address:	49.834970, -113.253753 +49° 50' 5.89", -113° 15' 13.51"
Distance:	30.6 mi (about 39 mins)

[Reverse directions](#)

1. Head east - go 0.2 mi
2. Turn left at HWY-5 - go 1.5 mi
3. Continue on Mayor Magrath Dr S - go 2.9 mi
4. Take the HWY-3 ramp to Ft MacLeod/Calgary/Medicine Hat - go 455 ft
5. Take the HWY-3 W ramp to Ft MacLeod/Calgary - go 23 mi

...

6. Turn right at Range Road 250 - go 3.4 mi
7. Arrive at **49.834970, -113.253753**
+49° 50' 5.89", -113° 15' 13.51"

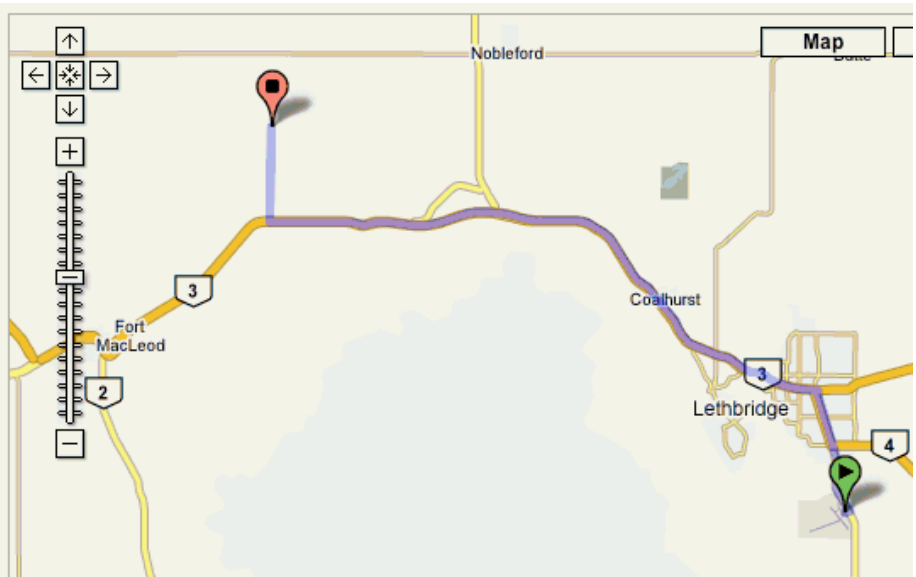

C. Johnson 21	P. Johnson 22	P. Johnson 23	P. Johnson 24	P. Johnson 25	P. Johnson 26	P. Johnson 27	P. Johnson 28	P. Johnson 29	P. Johnson 30	P. Johnson 31	P. Johnson 32	P. Johnson 33	P. Johnson 34	P. Johnson 35	P. Johnson 36	P. Johnson 37	P. Johnson 38	P. Johnson 39	P. Johnson 40	P. Johnson 41	P. Johnson 42	P. Johnson 43	P. Johnson 44	P. Johnson 45	P. Johnson 46	P. Johnson 47	P. Johnson 48	P. Johnson 49	P. Johnson 50	P. Johnson 51	P. Johnson 52	P. Johnson 53	P. Johnson 54	P. Johnson 55	P. Johnson 56	P. Johnson 57	P. Johnson 58	P. Johnson 59	P. Johnson 60	P. Johnson 61	P. Johnson 62	P. Johnson 63	P. Johnson 64	P. Johnson 65	P. Johnson 66	P. Johnson 67	P. Johnson 68	P. Johnson 69	P. Johnson 70	P. Johnson 71	P. Johnson 72	P. Johnson 73	P. Johnson 74	P. Johnson 75	P. Johnson 76	P. Johnson 77	P. Johnson 78	P. Johnson 79	P. Johnson 80	P. Johnson 81	P. Johnson 82	P. Johnson 83	P. Johnson 84	P. Johnson 85	P. Johnson 86	P. Johnson 87	P. Johnson 88	P. Johnson 89	P. Johnson 90	P. Johnson 91	P. Johnson 92	P. Johnson 93	P. Johnson 94	P. Johnson 95	P. Johnson 96	P. Johnson 97	P. Johnson 98	P. Johnson 99	P. Johnson 100
------------------	------------------	------------------	------------------	------------------	------------------	------------------	------------------	------------------	------------------	------------------	------------------	------------------	------------------	------------------	------------------	------------------	------------------	------------------	------------------	------------------	------------------	------------------	------------------	------------------	------------------	------------------	------------------	------------------	------------------	------------------	------------------	------------------	------------------	------------------	------------------	------------------	------------------	------------------	------------------	------------------	------------------	------------------	------------------	------------------	------------------	------------------	------------------	------------------	------------------	------------------	------------------	------------------	------------------	------------------	------------------	------------------	------------------	------------------	------------------	------------------	------------------	------------------	------------------	------------------	------------------	------------------	------------------	------------------	------------------	------------------	------------------	------------------	------------------	------------------	------------------	------------------	------------------	------------------	-------------------

70
71

72
73

74
75

1. MEDICINE NAT
2. SUFFIELD
3. WHILIA

R. 9
4 REDCLIFF
5 BOWELL
6 SEVEN PERSONS

R. 8

C.P.R.
W. of 4th M.

R. 7, Cummins Map C: 110-33
REGINA, SASK.

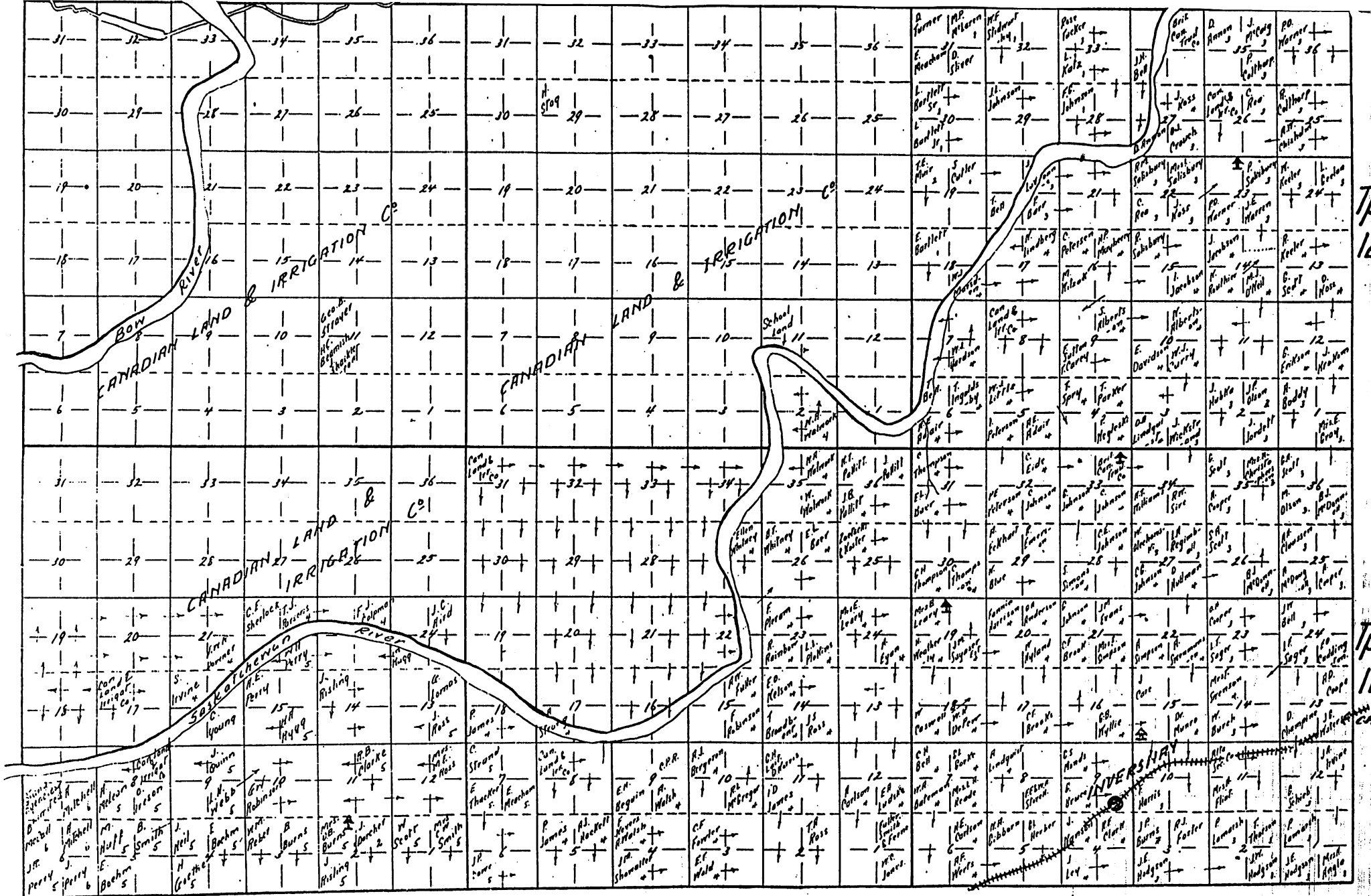

1. SUFFIELD
2. ALDERSON
3. WINNIPEG

R. 12 BOW ISLAND
5 BURDLEY
6 GRASSY LAKE

R. 11

W. of 4th M.

R. 10

No. 34

Tp. 12

Tp. 11

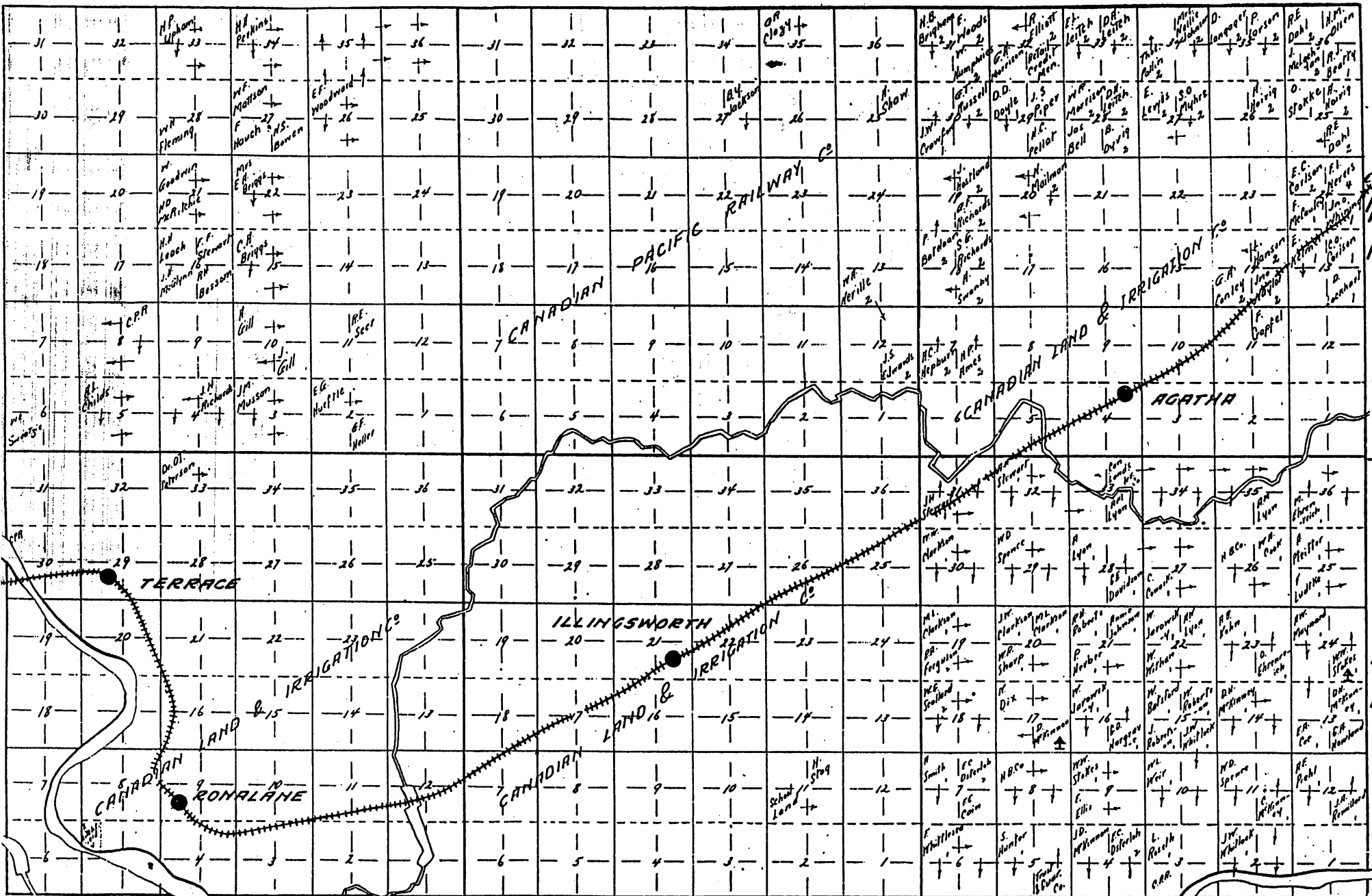

R 12

R 11

R 10

No. 34A

C.P.R.
Tp. 14

14
Tp. 13



31 32
30 29
19 20
18 17
7 8
6 5
31 32
30 29
19 20
18 17
7 8
6 5

31 32
30 29
19 20
18 17
7 8
6 5
31 32
30 29
19 20
18 17
7 8
6 5

31 32
30 29
19 20
18 17
7 8
6 5
31 32
30 29
19 20
18 17
7 8
6 5

31 32
30 29
19 20
18 17
7 8
6 5
31 32
30 29
19 20
18 17
7 8
6 5

31 32
30 29
19 20
18 17
7 8
6 5
31 32
30 29
19 20
18 17
7 8
6 5

31 32
30 29
19 20
18 17
7 8
6 5
31 32
30 29
19 20
18 17
7 8
6 5