

Have you ever wondered where your family homestead was in Southern Alberta?

Maybe you'll find their name on one of these old maps.

Alberta Homestead Maps - circa 1918

General Areas Covered on Each Map in #14 of 1918 Series:

Map #31 - Township 11 & 12 — Range 1, 2 & 3 — Walsh, Lamour, Irvine, Pashley

Map #31A - Township 13 & 14 — Range 1, 2 & 3 — North of Irvine, Vale

Map #32 - Township 11 & 12 — Range 4, 5 & 6 — Larkhall, Coleridge, Anstead, Medicine Hat, Dauntless, Fitzgerald

Map #32A - Township 13 & 14 — Range 4, 5 & 6 — Bowmanton, Cousins, Redcliff

Credit: Cummins Rural Directory Map

Would you like to see what the area looks like today?

Any parcel of land in Alberta can be located by its legal land description which is based on the Alberta Township Survey system. It is a grid network dividing the province into equal-sized parcels of land.

On a side column of the map you will find the Township (Tp) number.

Provide us with the **township number** (on the side column) and the **range number** (R - on the bottom of the map) **along with the name you are interested in.**

Send a check for \$30 U.S. (\$35 Can.) and \$10 U.S. \$12 Can.) for each additional name to:

Historical Research Centre

1115- 8 Ave. S.

Lethbridge, Alberta, Canada T1J1P7

Phone 403 328 3824

We will send you in jpeg form: (or hard copy if you prefer snail mail)

- 1 —A topographical map view of the area.**
- 2 —A google earth view from space of the area today**
- 3— Directions on how to reach the site**

Check out the next page to see an example.

Here is an example of what you get:

Let's say you wanted to find the site of the old Pearce Air Base where air crew from across the British Commonwealth were trained during World War II.

Once you tell us the township and the range numbers we will send you the following in jpeg form. (or hard copy if you prefer snail mail)

1 – A topographical map view of the area.



2 – A google earth view from space of the area today



3 – Directions on how to reach the site

Start address:	49.633686, -112.791309 +49° 38' 1.27", -112° 47' 28.71"
End address:	49.834970, -113.253753 +49° 50' 5.89", -113° 15' 13.51"
Distance:	30.6 mi (about 39 mins)

[Reverse directions](#)

1. Head east - go 0.2 mi
2. Turn left at HWY-5 - go 1.5 mi
3. Continue on Mayor Magrath Dr S - go 2.9 mi
4. Take the HWY-3 ramp to Ft MacLeod/Calgary/Medicine Hat - go 455 ft
5. Take the HWY-3 W ramp to Ft MacLeod/Calgary - go 23 mi

...

6. Turn right at Range Road 250 - go 3.4 mi
7. Arrive at **49.834970, -113.253753**
+49° 50' 5.89", -113° 15' 13.51"

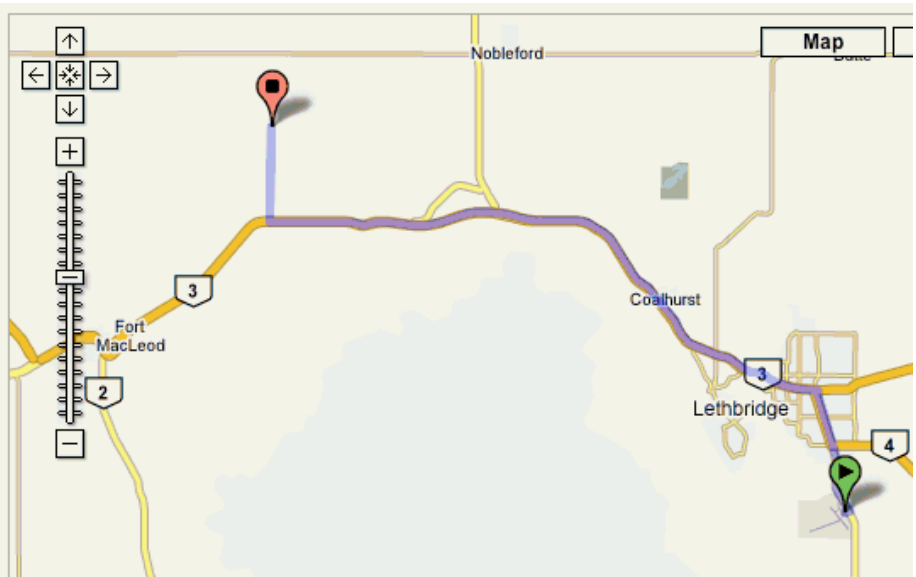

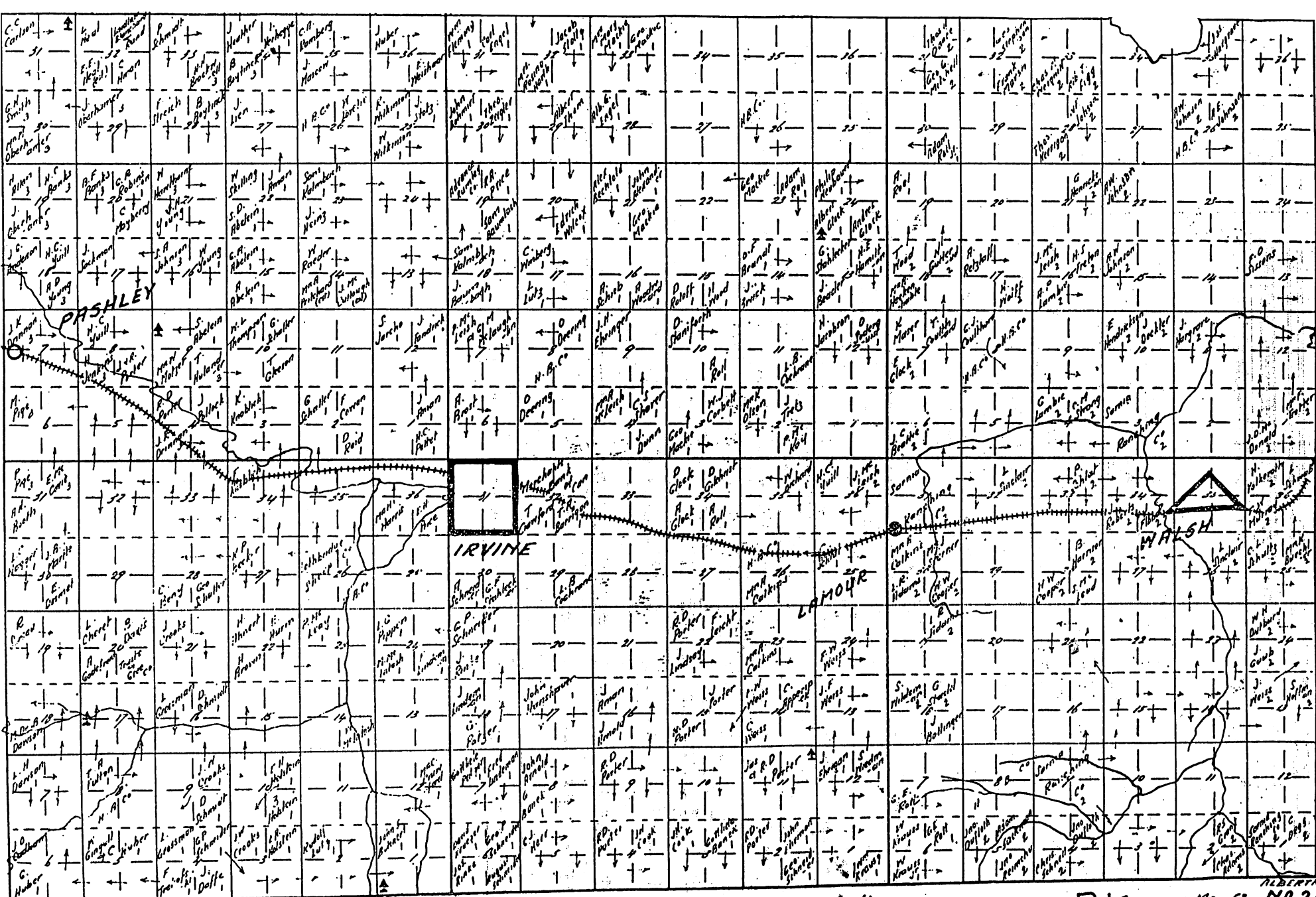

Tp. 12

Tp. 11

1 IRVINE
2 WALSH
3 PASHLEY

R.3
D. JARVIS
3 VALL

R.2
W. of 4th M.

R.1
CUMMINGS Map Co. No 31
WINNIPEG MAN.

1	2	3	4	5	6	7	8	9	10	11	12	13	14	15	16
17	18	19	20	21	22	23	24	25	26	27	28	29	30	31	32
33	34	35	36	37	38	39	40	41	42	43	44	45	46	47	48
49	50	51	52	53	54	55	56	57	58	59	60	61	62	63	64
65	66	67	68	69	70	71	72	73	74	75	76	77	78	79	80
81	82	83	84	85	86	87	88	89	90	91	92	93	94	95	96
97	98	99	100	101	102	103	104	105	106	107	108	109	110	111	112
113	114	115	116	117	118	119	120	121	122	123	124	125	126	127	128
129	130	131	132	133	134	135	136	137	138	139	140	141	142	143	144
145	146	147	148	149	150	151	152	153	154	155	156	157	158	159	160
161	162	163	164	165	166	167	168	169	170	171	172	173	174	175	176
177	178	179	180	181	182	183	184	185	186	187	188	189	190	191	192
193	194	195	196	197	198	199	200	201	202	203	204	205	206	207	208
209	210	211	212	213	214	215	216	217	218	219	220	221	222	223	224
225	226	227	228	229	230	231	232	233	234	235	236	237	238	239	240
241	242	243	244	245	246	247	248	249	250	251	252	253	254	255	256
257	258	259	260	261	262	263	264	265	266	267	268	269	270	271	272
273	274	275	276	277	278	279	280	281	282	283	284	285	286	287	288
289	290	291	292	293	294	295	296	297	298	299	300	301	302	303	304
305	306	307	308	309	310	311	312	313	314	315	316	317	318	319	320
321	322	323	324	325	326	327	328	329	330	331	332	333	334	335	336
337	338	339	340	341	342	343	344	345	346	347	348	349	350	351	352
353	354	355	356	357	358	359	360	361	362	363	364	365	366	367	368
369	370	371	372	373	374	375	376	377	378	379	380	381	382	383	384
385	386	387	388	389	390	391	392	393	394	395	396	397	398	399	400

Tp. 14

Tp. 13

R.3

R.2

R.1

No 31A

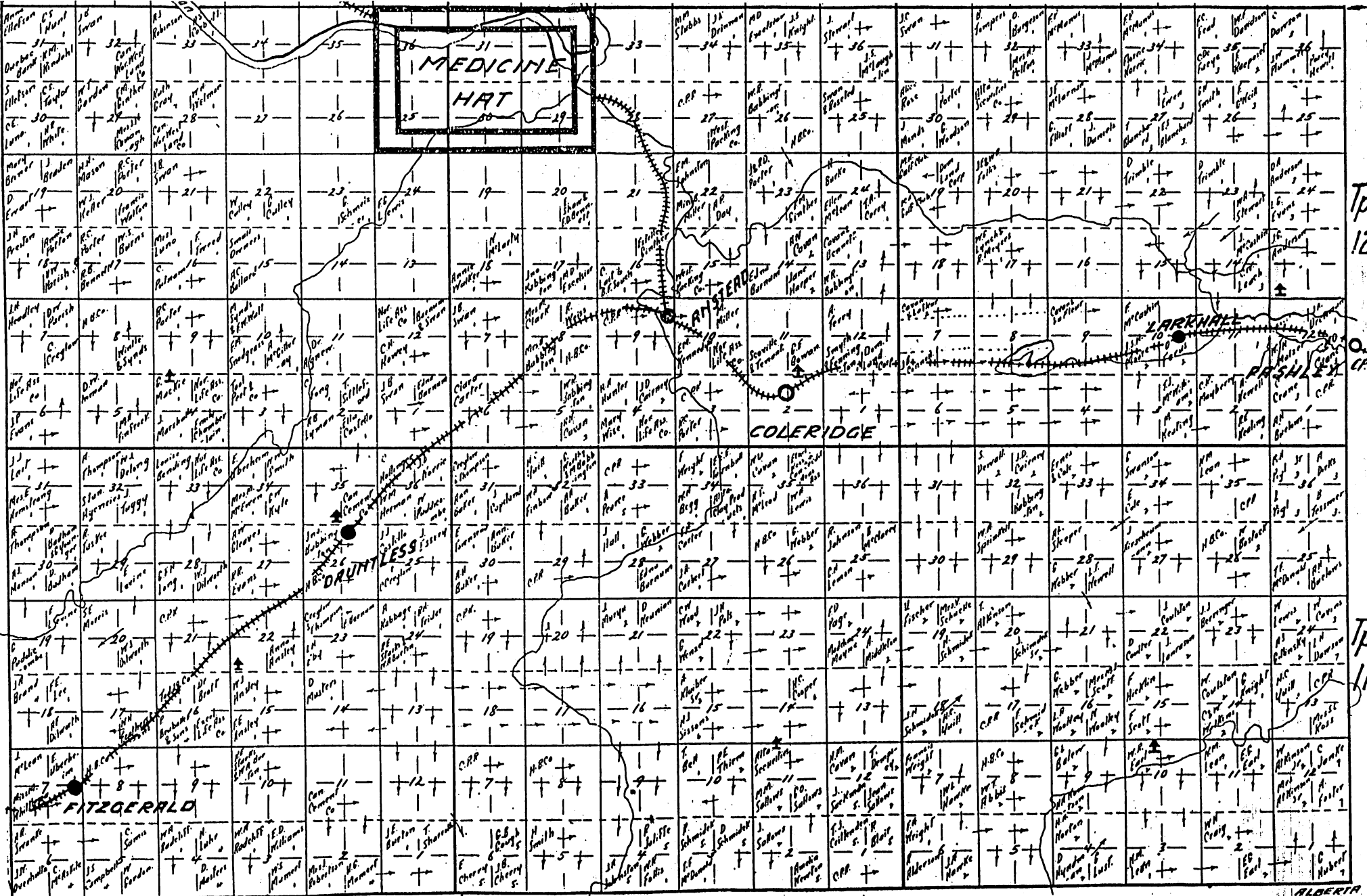

1. MEDICINE HAT
2. COLERIDGE
3. PASHLEY

R. 6 4. SEVEN PERSONS
5. WOOLCHESTER
6. REDCLIFF

7. IRVINE
8. BOWMANTON

R. 5

N. of 4th M

R. 4 Cummins Map 6.
REGINA, SASK. No 32

Tp. 12

Tp. 11

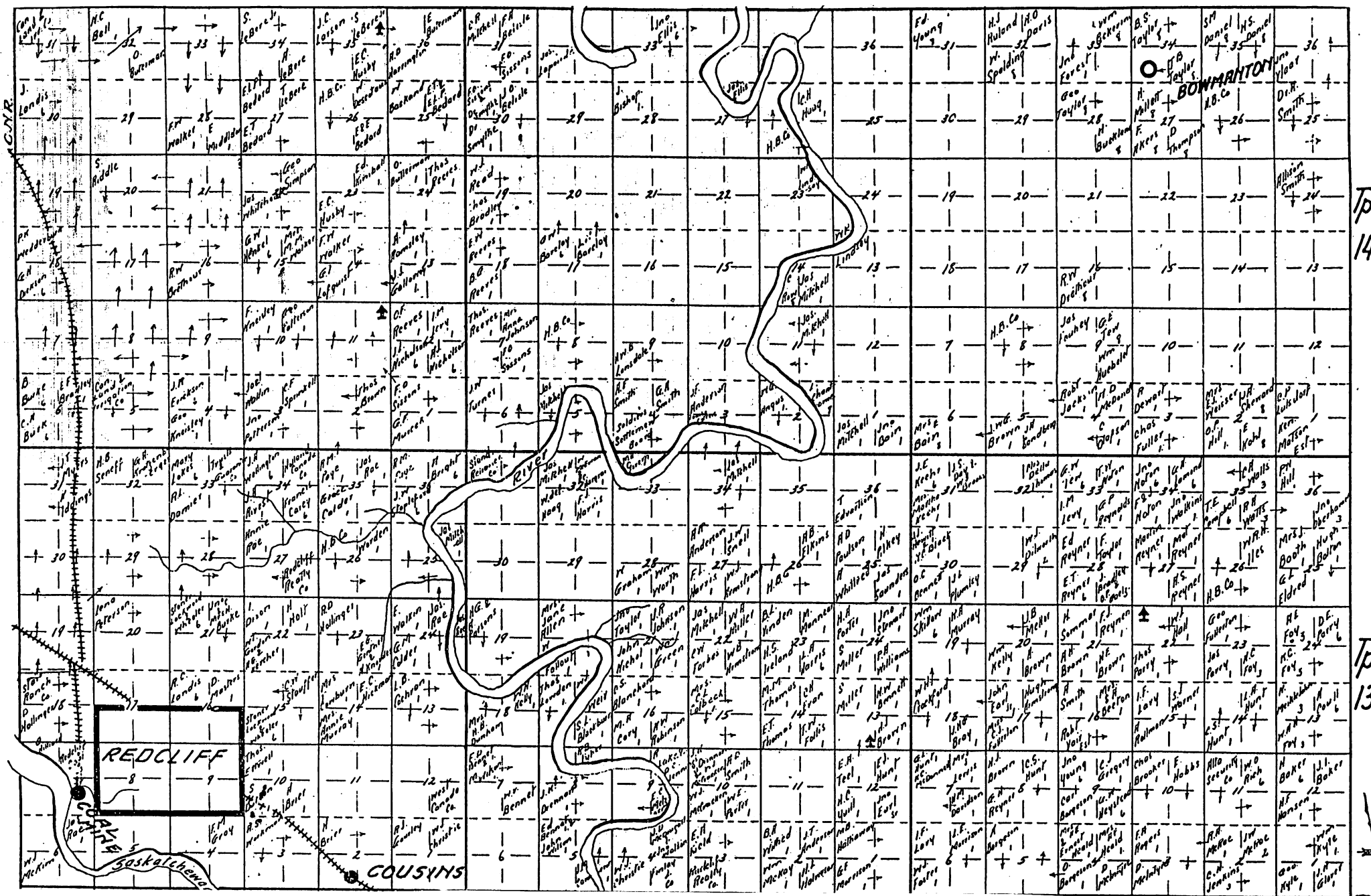

R.6

R.5

R.4

No 32A

Tp. 14

Tp. 13